

CATALOG #	TYPE	
JOB NAME	WATTAGE	VOLTAGE

6" T4.5 CERAMIC METAL HALIDE 70 WATT MAXIMUM HRS-06315

Ellipsoidal T4.5 Lensed Square Wall Wash
70, 39 or 20 Watt in a variety of beam spreads

THIS PRODUCT IS NO LONGER AVAILABLE

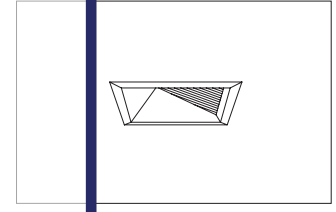

Specifications

Lamp

- Designed for 25° offset T4.5 bi-pin or T4 twist-and-lock (see Option -T4) ceramic metal halide lamp.
- Up to 95 CFM, 12,000-15,000 hour life.
- For lower wattages, see Option -43.

Socket (5kV rated)

- G8.5 base. (UL6.5 base for T4 (Option -T4).
- Porcelain body. Silicone leads.

Reflectors

- Upper: Ellipsoidal specular Alzak® aluminum.
- Lower: Low brightness angle cut square specular Alzak® aluminum, self-flange.
- Optional reflector finishes / colors available.

Lens: UV Absorbing

- Frosted lens glass lens mounted on reflector.

Electronic Ballast

- Full electronic circuitry provides constant color and consistent performance for long life.
- Input voltage 120-277V, 50/60 Hz. For other voltages, see Options.

- 70 watt standard. Add Option -41 and specify for 39 or 20 watt. For option -42, 39 watt standard or add Option -43 for type to 20 watt.
- Minimum starting temperature 20°C/-4°F.
- Temperature correction factor less than 1.5.
- Temperature protection provides automatic shut-off and restart features as needed.
- Internally fused.
- Power factor greater than 90%.
- Input current THD less than 15%.
- Maximum 90°C operation, Sound Rated A.
- Includes lamp end-of-life detection and shut-off circuitry.
- Removable mounting.
- Acrylic enameled. Rustproof. Corrosion resistant. Exposed bulb. ETL M3300.
- Control circuitry has a 100,000 hour life.
- Cool operation: Extends component life. Minimizes HVAC load.
- Through-bracket screw-in bracket for easy removal.
- Built-in plaster frame.

lookAlike™ to Downlight or Adjustable (Optional T4)

Outlet Box

- Prewired 14 GA (NEC) galvanized steel, UL listed; with removable insulated cover.
- 1/2" and 3/4" knockouts.

Installation

- 27" galvanized hanger bars with adjustable mounting brackets (2) supplied.
- Recesses indoor or outdoor in covered locations.

UL, C-UL (Canada) Listings

- Wet, damp or dry locations, covered ceilings.
- Through-bracket circuit conductors (6 #12).
- Three Year Limited Warranty
- Complete standard fixture, including ballast.

Please consult QUOTATIONS for the best alternative.

Performance at a Glance

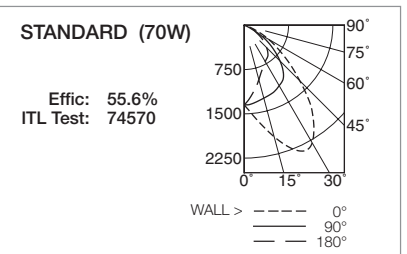
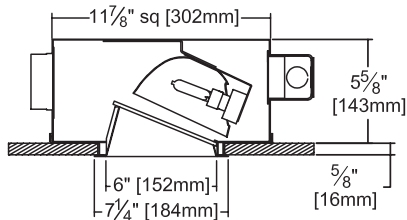

Ceiling Cut-out 6 3/4" Sq.

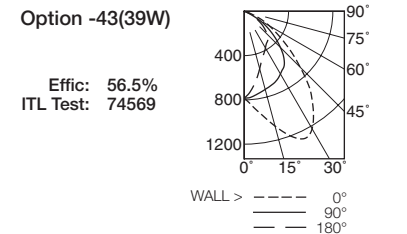
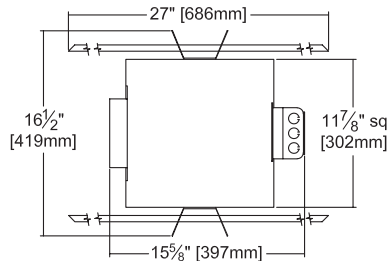

THE KIRLIN COMPANY

3401 EAST JEFFERSON AVENUE • DETROIT, MICHIGAN 48207-4232
(313) 259-6400 • Fax: (313) 259-9409 OR (313) 259-3121 • www.kirlinlighting.com

COMPACT PULSE START
METAL HALIDE LIGHTING

MAXIMUM WATTAGE

70

CATALOG NUMBER

HRS-06315

DUE TO OUR CONTINUING EFFORT TO IMPROVE PRODUCTS, TECHNICAL INFORMATION IS SUBJECT TO CHANGE WITHOUT NOTICE.

Alzak® is a registered trademark of ALCOA.

Detailed Photometry - Installed Fixture

Photometry from I.T.L., Boulder, CO

STANDARD (70W)

Effic: 55.6%
ITL Test: 74570

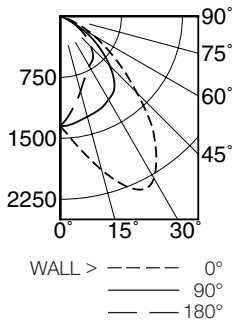

CANDLEPOWER DISTRIBUTION					
	0.0	45.0	90.0	135.0	180.0
0	1348	1348	1348	1348	1348
5	1512	1455	1339	1251	1218
15	1955	1703	1278	1050	954
25	2351	1936	1228	859	771
35	2053	1899	1136	676	675
45	1328	1568	856	545	534
55	704	1047	477	261	325
65	265	498	89	35	151
75	47	70	4	0	1
85	0	0	0	0	0
90	0	0	0	0	0

DISTANCE FROM CEILING IN FEET	SINGLE FIXTURE					MULTIPLE FIXTURES					
	1'	2'	3'	4'	3' CENTERS		4' CENTERS				
	FOOTCANDLE DISTRIBUTION ON WALL SURFACE										
1	60.2	45.9	17.3	3.6	1.5	70.2	72.6	70.2	15.0	14.6	15.0
2	120.0	94.3	52.1	18.8	5.7	180.0	160.0	160.0	56.2	58.1	56.2
3	92.8	78.2	47.7	23.8	11.2	145.0	142.0	145.0	79.8	81.8	79.8
4	54.4	48.5	33.5	20.6	11.7	104.0	103.0	104.0	78.8	78.1	78.8
5	30.3	28.1	22.0	15.4	10.2	70.6	72.3	70.6	67.3	66.2	67.3
6	18.0	17.0	14.4	11.1	8.2	49.6	51.3	49.6	53.2	53.4	53.2
7	11.6	11.1	9.8	8.1	6.4	37.7	38.2	37.7	41.8	43.0	41.8
8	8.1	7.9	7.2	6.2	5.1	29.8	30.0	29.8	34.1	34.7	34.1
9	6.3	6.2	5.7	5.1	4.3	24.9	25.2	24.8	28.6	29.0	28.6

Option -43(39W)

Effic: 56.5%
ITL Test: 74569

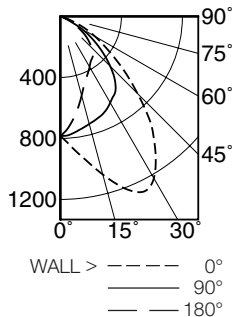

CANDLEPOWER DISTRIBUTION					
	0.0	45.0	90.0	135.0	180.0
0	784	784	784	784	784
5	861	833	776	731	715
15	1073	945	730	603	537
25	1270	1051	689	476	420
35	1087	1006	620	363	351
45	715	809	462	274	286
55	377	549	255	137	175
65	159	270	52	19	83
75	25	39	3	0	1
85	0	0	0	0	0
90	0	0	0	0	0

DISTANCE FROM CEILING IN FEET	SINGLE FIXTURE					MULTIPLE FIXTURES					
	1'	2'	3'	4'	3' CENTERS		4' CENTERS				
	FOOTCANDLE DISTRIBUTION ON WALL SURFACE										
1	34.9	26.5	10.0	2.0	0.8	40.5	42.0	40.4	8.2	8.0	8.2
2	64.3	50.0	27.5	10.1	3.1	86.0	84.4	86.0	30.4	31.4	30.3
3	49.2	41.3	24.7	12.4	5.8	76.3	74.5	76.3	42.8	43.2	42.8
4	29.3	26.1	17.8	10.7	6.1	55.2	55.3	55.2	41.5	41.0	41.5
5	16.5	15.2	11.9	8.1	5.3	37.6	38.8	37.6	35.5	35.0	35.5
6	9.8	9.3	7.8	5.9	4.3	26.7	27.5	26.7	28.2	28.5	28.2
7	6.3	6.1	5.4	4.4	3.4	20.4	20.6	20.4	22.3	23.0	22.3
8	4.5	4.4	3.9	3.4	2.8	16.2	16.3	16.2	18.0	18.6	18.0
9	3.5	3.4	3.2	2.8	2.3	13.5	13.7	13.5	15.4	15.6	15.4

Photometry based on: 6200 lumens - 70W
3300 lumens - 39W

Options

Lower Reflector (Self-Flanged)

- 30 All White. (CP x 1.1)
- 31 White flange (only).
- 32 White trim extender to cover larger ceiling opening. Specify outer square dimension.
- 45 Gasket above flange. Stops dust streaks on ceiling.
- 70 Clear SofTex. (CP x .92)
- 94 Custom color. Consult factory.

Relays, Standbys, Lamps

- 49 Extra circuit DCB socket (up to 75W). Do not energize simultaneously with main source. Also see Option -LS.
- 65 Electronic standby system and DCB socket (up to 75W). Provides immediate light until CMH restrikes. Also see Options -66 and -LS.
- 66 Electronic time delay standby system and DCB socket (up to 75W). Provides light until CMH reaches 70% output. Also see Option -LS.
- LP With lamp. Specify source, wattage, color temperature / brand. 3000°K standard; consult factory for others.
- LS With T4 DCB tungsten halogen standby lamp (75W). Use only with Options -49, -65 or -66.

Wattage and Voltage

- 43 Lower wattage:
T4.5: specify 39W or Type IC 20W
With Option -T4: Type IC 20W only
- 347 347 volt.
- 97 Other input voltage instead. Consult factory.
- T4 Converted to GU6.5 base for twist-and-lock T4 lamp. 39W standard. Add Option -43 for 20 watt Type IC.

Other

- 99 Special modification. Consult factory.

SUBMITTAL DATA

JOB NAME

TYPE

WATTAGE

VOLTAGE

CATALOG NUMBER

APPROVAL STAMP

LIMITED WARRANTY: KIRLIN FIXTURES ARE WARRANTED FREE OF DEFECTS IN WORKMANSHIP OR MATERIAL FOR THREE YEARS FROM DATE OF PURCHASE. INSTALLATION IN NORMAL USE. Manufacturer of the fixture will replace or repair each fixture or refund the purchase price on replacement of a fixture if the fixture is found to be defective in workmanship or material. This warranty is void if the fixture is not installed in accordance with the manufacturer's instructions. The manufacturer is not responsible for any damage to property or injury to persons. This warranty is supplied to the buyer on the face of all orders. Manufacturer's expressed or implied sales does not warrant as to merchantability or fitness for a particular use. No other statement constitutes a warranty or amend this specific warranty. Abnormal use, abuse of the fixture, improper installation, or repair, or modification of the fixture without prior written authorization from the manufacturer will render the warranty void.