

CATALOG #	TYPE
JOB NAME	WATTAGE VOLTAGE

4" T4.5 CERAMIC METAL HALIDE 70 WATT MAXIMUM

HRS-04312

Parabolic T4.5 Square Adjustable Architectural Highlighting Two-Dimensional

Specifications

Lamp

- Designed for adjustable T4.5 bi-pin or T4 twist-and-lock (see Option -T4) ceramic metal halide lamp.
- Up to 95 CPM, 12,000-15,000 hour life.
- For lower wattages, see Option -43.

Socket (5kV rated)

- G8.5 base, G16.5 base for T4 (Option -T4).
- Porcelain body. Silicone leads.

Reflectors

- Upper: Parabolic specular Alzak® aluminum. Swivels 358° tilts up to 45°.
- Lower: Low brightness square specular Alzak® aluminum, self-flanged.
- Optional reflector finishes / colors available.

Lens: UV Absorbing

- Microprismatic glass mounted to wet mount reflector. Standard NFL distribution.
- See Options for -MFL (0.8 SC) distribution.

Electronic Ballast

- Full electronic circuit provides constant color and constant wattage, ensuring consistent performance and long life.

THIS PRODUCT IS NO LONGER AVAILABLE

Please consult
QUOTATIONS
for the best alternative.

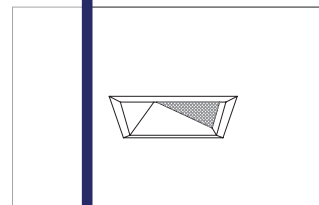

70, 39 or 20 Watt
(Optional T4)

- Built-in plaster frame.
- Outlet Box**
- Prewired 14 GA (NEC) galvanized steel, UL listed; with removable insulated cover.
- 1/2" and 3/4" knockouts.
- Installation**
- 27" galvanized hanger bars with adjustable mounting brackets (2) supplied.
- Recesses indoor or outdoor in covered locations.
- UL, C-UL (Canada) Listings**
- Wet, damp or dry locations, covered ceilings.
- Through-branch circuit conductors (6 #12).
- 20 watt only.
- Limited Warranty**
- Complete standard fixture, including ballast.

Performance at a Glance

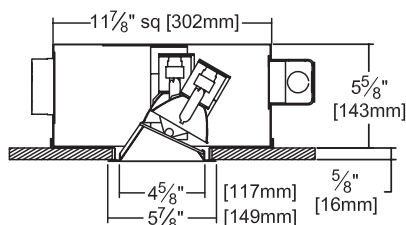

Ceiling Cut-out
5 1/4" Sq.

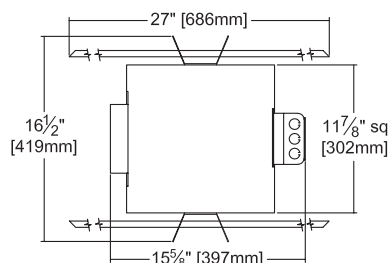

STANDARD (NFL) DISTRIBUTION (70W)

SC: 0.4
Effic: 53.0%
ITL Test: 66625

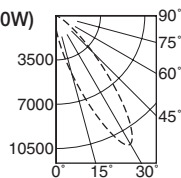

Option -MFL (70W)

SC: 0.8
Effic: 55.1%
ITL Test: 66627

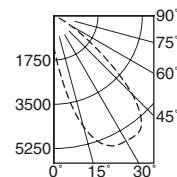

Option -43(39W) (NFL)

SC: 0.4
Effic: 52.5%
ITL Test: 66629

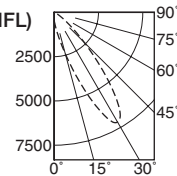

Options -43(39W)-MFL

SC: 0.8
Effic: 54.3%
ITL Test: 66631

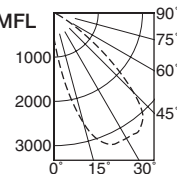

THE KIRLIN COMPANY

3401 EAST JEFFERSON AVENUE • DETROIT, MICHIGAN 48207-4232
(313) 259-6400 • Fax: (313) 259-9409 OR (313) 259-3121 • www.kirlinlighting.com

COMPACT PULSE START METAL HALIDE LIGHTING

MAXIMUM WATTAGE

70

CATALOG NUMBER

HRS-04312

DUE TO OUR CONTINUING EFFORT TO IMPROVE PRODUCTS, TECHNICAL INFORMATION IS SUBJECT TO CHANGE WITHOUT NOTICE.

Alzak® is a registered trademark of ALCOA.

