

Recessed Lensed T-6 Bi-Pin & E-Lamp Downlights. 50 to 150 Watt

THIS PRODUCT IS NO LONGER AVAILABLE

Please consult QUOTATIONS

for the best alternative.

Features

Lamp

- Designed for medium base metal halide T-6 bi-pin or standard and optional wattages.
- See Option -43 and chart below for lower wattage for HPS availability.

Socket

- Vertical. Pulse rated. Glazed porcelain.
- Nickel-plated brass screw shell. Standard leads.

Reflectors

- Upper: Ellipsoidal or parabolic specular Alzak® aluminum.
- Lower: SoftTex softly etched pewter or black aluminum. Self-flanged. Gasketed.

Lens

- UV absorbing clear tempered glass mounted to upper reflector.
- HRS-04160 only: Tempered Microlux glass.

Ballast Assembly: Specialty Voltage

- Class H, high reactance for 120 volt, linear reactor for 277 volt.
- Capacitor and ignitor supplied.
- Dimming (-39) and electronic (-96) ballasts available. See Options.
- Cool: Dissipates heat across entire surface and is protected from moisture.

Fuse

- 50-150 watt: Class H, high reactance for 120 volt, linear reactor for 277 volt.

Hot Surface

- Acrylic chamfered aluminum.
- Exceeds 1000 hr. of thermal spray test.

150W
4" 100W

HRS-04160
HRS-04161

- Entire luminaire serviced from below through removable reflector.
- Built-in plaster name.

Outlet Box

- Rewired 14 GA (NEC) galvanized steel, UL listed; with removable insulated cover.
- 1/2" and 3/4" knockout.

Installation

- 27" galvanized hanger bars supplied (2).
- Fully adjustable universal mounting brackets supplied (2).
- Recesses indoor or outdoor in covered locations.

UL, C-UL (Canada) Listings

- Wet, damp or dry locations, covered ceilings.
- Through-branch circuit conductors (6 #12).

Three Year Limited Warranty

- Complete standard fixture, including ballast.
- Per current NEC.

Wattage Availability and Cut-Out Dimensions

Catalog No.	Lamp/Base	Standard Wattage		Option -43: Lower Wattage		Max. Standby Wattage (-49-65-66-LS)	Ceiling Cut-Out
		Pulse MH	-24 (HPS)	Pulse MH	-24 (HPS)		
HRS-04160	T-6/G12/Bi-pin	150	—	39-70	—	100	5.25" Sq.
HRS-04161	ED-17/Med	100	100	50-70	35-70	75	5.25" Sq.

Options

Sources and Ballasts

- 24 HPS ballast instead. See wattage chart above for available wattages. Specify voltage.
- 39 Electronic dimming ballast instead for pulse start metal halide. Consult factory for wattage and voltage availability.
- 96 Regulating electronic MH ballast instead.

Wattage and Voltage

- 43 Lower wattage: See Option -43 chart above for available lower wattages. Specify voltage.
- 120 120 volt, 60 Hz. ballast.
- 277 277 volt, 60 Hz. ballast.
- 347 347 volt, 60 Hz. ballast. Consult factory for dimming or electronic.
- 97 Other voltage ballast. Consult factory.

Relays, Standbys, Lamps (See Chart)

- 49 Extra circuit DCB socket. Do not energize simultaneously with main source. Also see -LS.
- 65 Electronic standby system and DCB socket.

- Following HID outage, provides immediate light until HID restrikes. Also see -66 and -LS.
- 66 Electronic time delay standby system and DCB socket. Following outage, provides light until HID reaches 70% output. Also see Option -LS.
- LP With lamp. Specify source, wattage, color temperature, and clear or coated. (3700°K standard for metal halide)
- LS With T-4 DCB tungsten halogen standby lamp. Use only with Options -49, -65 or -66.

Reflectors and Trims (Self-Flanged)

- 16 Champagne Gold specular Alzak lower reflector. (CP x 1.10)
- 30 All White lower reflector. (CP x 1.10)
- 31 White flange (only) on lower reflector.
- 32 Trim extender. Broadens trim flange O.D. by 1".
- 45 Gasket above reflector flange for HRS-06162.
- 62 Clear specular Alzak lower reflector. (CP x 1.16)
- 63 Dune specular Alzak lower reflector. (CP x 1.08)
- 69 Wheat specular Alzak lower reflector. (CP x 1.07)
- 71 SoftTex Dune etched lower reflector. (CP x .97)
- 72 Black specular Alzak lower reflector. (CP x .89)
- 77 SoftTex Pewter etched lower reflector. (CP x .92)

- 90 SoftTex Champagne Gold lower reflector. (CP x .97)
- 91 SoftTex Wheat etched lower reflector. (CP x .95)
- 92 Umber specular Alzak lower reflector. (CP x .96)
- 93 Pewter specular Alzak lower reflector. (CP x 1.02)
- 94 Custom color lower reflector instead. Consult factory.

Lenses

- 15 Prismatic C#73 flat glass lens instead.
- 28 UV absorbing clear tempered glass instead. (Standard for HRS-04161)
- ML UV absorbing tempered Microlux glass instead. (Standard for HRS-04160)

Mounting Options

- 79 Extension collar for up to 2" thick ceilings.
- 85 Ceiling Panel; with recessed fixture hole. Lays-in 2' x 2' grid. White.

Other Options

- 99 Special modification. Consult factory.
- TA Top access modification for servicing from above ceiling.

HRS-04160 HRS-04161

Plan View

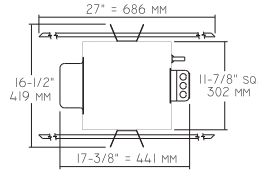

Cone of Light Key

- Ft.** Distance from fixture
 - FC** Footcandles (average)
 - Dia.** Circle of light at 50% of FC
- * Dia. (in ft.) shown is where FC value is half the FC at nadir.

C.U. (Coefficients of Utilization) Tables are available on request. Please contact your Kirlin representative.

LIMITED WARRANTY: CATALOGED KIRLIN FIXTURES ARE WARRANTED FREE OF DEFECTS IN WORKMANSHIP OR MATERIAL FOR THREE YEARS FROM DATE OF PURCHASE. INSTALLLED TO N.E.C. IN NORMAL USE. Manufacturer at his option will replace or repair, at no charge, any fixture found to be defective in workmanship or material, provided the purchaser presents the fixture to the manufacturer or its authorized representative for inspection and repair. This warranty is limited to the original purchaser and is not transferable. It is void if the fixture is used for any other than normal use, or if it is altered, modified, repaired, or if it is used in an environment where it is not intended to be used. Seller does not warrant as to merchantability or fitness for a particular use, nor will any oral statement constitute a warranty or amend this specific warranty. Abnormal use, abuse or other improper installation, or modification of the fixture without prior written authorization from the manufacturer will render the warranty void.

HRS-04160 150W

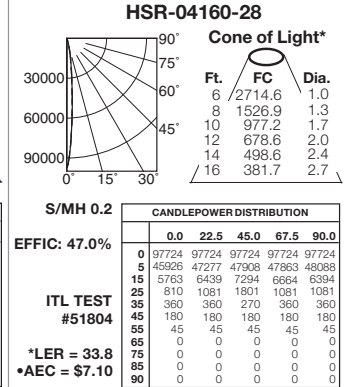
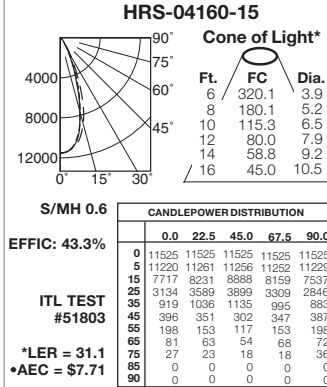
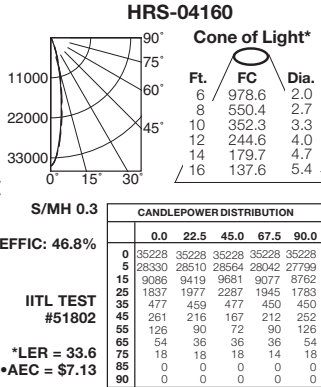
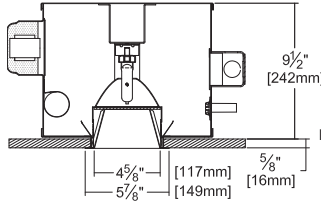

HRS-04161 100W

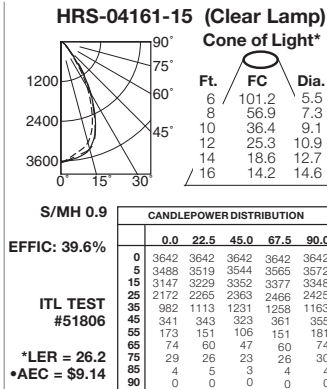
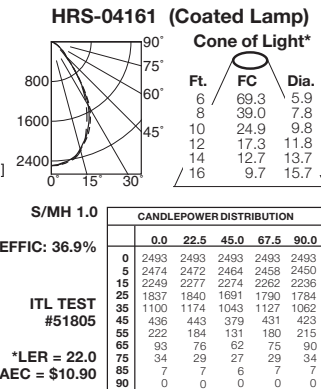
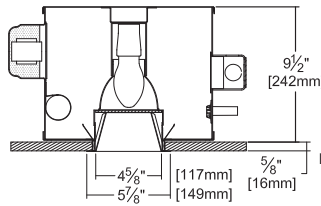

* LER (Luminaire Efficacy Rating) = Luminaire Effic. x Total Lamp Lumens x Ballast Factor / Input Watts

* AEC = Annual Energy Cost per 1000 lumens (based on 3000 hours use @ \$0.08 KWH).

SUBMITTAL DATA

APPROVAL STAMP

JOB NAME

TYPE

WATTAGE

VOLTAGE

CATALOG NUMBER