

Recessed Lensed E-Lamp
Horizontal Downlight
150 to 250 Watt

11" 250W

HRR-11073

THIS PRODUCT IS NO LONGER AVAILABLE

Please consult
QUOTATIONS
for the best alternative.

Features

Lamp

- Designed for mogul base metal halide E-lamps. See chart for standard and lower wattages.
- See Option -43 and chart for lower wattage or HPS availability.

Socket

- Horizontal. Pulse rated. Glazed porcelain.
- Nickel-plated brass screw shell. Silicone leads.

Reflector

- Specular Alzak® aluminum.

Trim Assembly

- Seamless tapered black OptiGlove™ flanged white trim.
- UV absorbing tempered prismatic brightness C#73 flat glass lens.
- Optional trim flange available.

Ballast Assembly

- WhisperPack™ fully encapsulated 180°C rated HPS pulse start ballast.

- Entire luminaire serviced through removable trim assembly.
- Built-in plaster frame.

Outlet Box

- Prewired 14 GA (NEC) galvanized steel, UL listed; with removable insulated cover.
- 1/2" and 3/4" knockouts.

Installation

- 27" galvanized hanger bars supplied (2).
- Fully adjustable universal mounting brackets supplied (2).
- Recesses indoor or outdoor in covered locations.

UL, C-UL (Canada) Listings

- Wet, damp or dry locations, covered ceilings.
- Through-bracket circuit conductors (6 #12).

Three Year Limited Warranty

- Standard fixture, including ballast.

Thermal Protection

- Per current NEC.

Wattage Availability and Cut-Out Dimensions

| Catalog No. | Lamp/Base | Standard Wattage | | Option -43: Lower Wattage | | Max. Standby Wattage (-49-65-66-LS) | Ceiling Cut-Out Diameter |
|-------------|-----------|------------------|-----------|---------------------------|-----------|-------------------------------------|--------------------------|
| | | Pulse MH | -24 (HPS) | Pulse MH | -24 (HPS) | | |
| HRR-11073 | ED-28/Mog | 250 | 250 | 150-200 | 150 | 150 | 12.25" |

Options

Sources and Ballasts

- 24 HPS ballast instead. See wattage chart above for available wattages. Specify voltage.
- 39 Electronic dimming ballast instead, for pulse start metal halide. Consult factory for wattage and voltage availability.
- 96 Regulating electronic MH ballast instead. Consult factory for availability.

Wattage and Voltage

- 43 Lower wattage: See Option -43 chart above for available lower wattages. Specify voltage.
- 120 120 volt, 60 Hz. ballast.
- 277 277 volt, 60 Hz. ballast.
- 347 347 volt, 60 Hz. ballast. Consult factory for dimming or electronic.
- 97 Other voltage ballast instead. Consult factory.

Relays, Standbys, Lamps (See Chart)

- 49 Extra circuit DCB socket. Do not energize simultaneously with main source. Also see -LS.
- 65 Electronic standby system and DCB socket. Following HID outage, provides immediate light until HID restrikes. Also see -66 and -LS.
- 66 Electronic time delay standby system and DCB socket. Following outage, provides light until HID reaches 70% output. Also see Option -LS.
- HL Hi-Lo wiring modification for use with external relay systems (by others). 175W or above. CWA ballast only. Specify system.
- LP With lamp. Specify source, wattage, color temperature, and clear or coated. (3700°K standard for metal halide)
- LS With T-4 DCB tungsten halogen standby lamp. Use only with Options -49, -65 or -66.

Lenses and Trims

- 32 Trim extender. Broadens trim flange O.D. by 1" to cover larger ceiling opening.
- 40 White grooveless flare trim assembly instead.
- 45 Gasket between trim and ceiling.
- 46 Gasket between trim and lens.
- 94 Custom color trim assembly. Consult factory.
- FR Fresnel tempered lens instead.
- FT Flat white trim instead. With standard C#73 lens or specify optional lens.
- HO Holographic concave lens instead.

Mounting Options

- 79 Extension collar for up to 2" thick ceilings.

Other Options

- 99 Special modification. Consult factory.
- TA Top access modification for servicing from above ceiling.

KIRLIN

THE KIRLIN COMPANY

3401 EAST JEFFERSON AVENUE • DETROIT, MICHIGAN 48207-4232
(313) 259-6400 • Fax: (313) 259-9409 or (313) 259-3121 • www.kirlinlighting.com

HRR-11073

Plan View

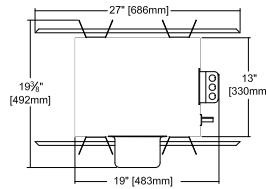

Cone of Light Key

- Ft.** Distance from fixture
 - FC** Footcandles (average)
 - Dia.** Circle of light at 50% of FC
- * Dia. (in ft.) shown is where FC value is half the FC at nadir.

C.U. (Coefficients of Utilization) Tables are available on request. Please contact your Kirlin representative.

LIMITED WARRANTY: CATALOGED KIRLIN FIXTURES ARE WARRANTED FREE OF DEFECTS IN WORKMANSHIP OR MATERIAL FOR THREE YEARS FROM DATE OF PURCHASE. INSTALLED TO N.E.C. IN NORMAL USE. Manufacturer at the option will replace or repair, at no charge, any fixture or component thereof found to be defective in workmanship or material, provided that the fixture is returned to the manufacturer with proof of purchase and a copy of this warranty. This warranty is void if the fixture is not installed to N.E.C. in normal use. This warranty is void if the fixture is not installed to N.E.C. in normal use. This warranty is void if the fixture is not installed to N.E.C. in normal use. This warranty is void if the fixture is not installed to N.E.C. in normal use.

HRR-11073 250W

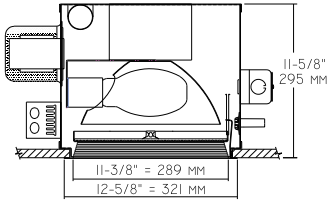

HRR-11073 (Coated Lamp)

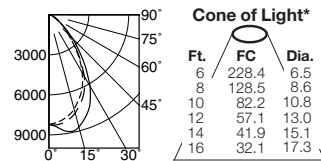

- 0° S/MH 1.0
- 90° S/MH 1.1
- 180° S/MH 1.0

EFFIC: 58.0%
ITL TEST #51390
*LER = 40.0 *AEC = \$6.00

| | CANDLEPOWER DISTRIBUTION | | | | |
|----|--------------------------|------|------|-------|-------|
| | 0.0 | 45.0 | 90.0 | 135.0 | 180.0 |
| 0 | 8221 | 8221 | 8221 | 8221 | 8221 |
| 5 | 8051 | 8272 | 8525 | 8405 | 8251 |
| 15 | 7317 | 8132 | 8705 | 8231 | 7611 |
| 25 | 5942 | 6743 | 7317 | 6743 | 6276 |
| 35 | 3979 | 4393 | 4794 | 4332 | 4100 |
| 45 | 2057 | 2209 | 2497 | 2170 | 2123 |
| 55 | 988 | 1102 | 1068 | 1061 | 1014 |
| 65 | 454 | 504 | 540 | 481 | 441 |
| 75 | 187 | 220 | 240 | 214 | 187 |
| 85 | 6 | 6 | 6 | 6 | 6 |
| 90 | 0 | 0 | 0 | 0 | 0 |

HRR-11073-FR (Coated Lamp)

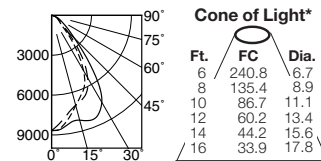

- 0° S/MH 0.9
- 90° S/MH 1.2
- 180° S/MH 1.0

EFFIC: 58.0%
ITL TEST #51392
*LER = 40.0 *AEC = \$6.00

| | CANDLEPOWER DISTRIBUTION | | | | |
|----|--------------------------|------|------|-------|-------|
| | 0.0 | 45.0 | 90.0 | 135.0 | 180.0 |
| 0 | 8668 | 8668 | 8668 | 8668 | 8668 |
| 5 | 8452 | 8452 | 8452 | 8452 | 8452 |
| 15 | 7023 | 7023 | 7023 | 7023 | 7023 |
| 25 | 5848 | 5848 | 5848 | 5848 | 5848 |
| 35 | 3431 | 3431 | 3431 | 3431 | 3431 |
| 45 | 1148 | 1148 | 1148 | 1148 | 1148 |
| 55 | 655 | 655 | 655 | 655 | 655 |
| 65 | 427 | 427 | 427 | 427 | 427 |
| 75 | 160 | 160 | 160 | 160 | 160 |
| 85 | 6 | 6 | 6 | 6 | 6 |
| 90 | 0 | 0 | 0 | 0 | 0 |

HRR-11073-HO (Coated Lamp)

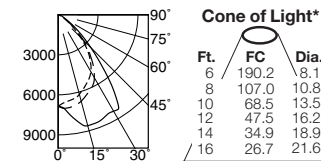

- 0° S/MH 1.1
- 90° S/MH 1.5
- 180° S/MH 1.2

EFFIC: 63.7%
ITL TEST #51393
*LER = 43.9 *AEC = \$5.47

| | CANDLEPOWER DISTRIBUTION | | | | |
|----|--------------------------|------|------|-------|-------|
| | 0.0 | 45.0 | 90.0 | 135.0 | 180.0 |
| 0 | 6847 | 6847 | 6847 | 6847 | 6847 |
| 5 | 6570 | 6816 | 7237 | 7163 | 7023 |
| 15 | 6169 | 7424 | 8605 | 7490 | 6703 |
| 25 | 5394 | 6890 | 8399 | 6963 | 5995 |
| 35 | 4206 | 5714 | 7624 | 5408 | 4593 |
| 45 | 2363 | 3158 | 3484 | 2891 | 2630 |
| 55 | 895 | 1289 | 1281 | 1049 | 961 |
| 65 | 294 | 447 | 441 | 347 | 267 |
| 75 | 133 | 201 | 220 | 187 | 121 |
| 85 | 6 | 6 | 6 | 6 | 6 |
| 90 | 0 | 0 | 0 | 0 | 0 |

* LER (Luminaire Efficacy Rating) = Luminaire Effic. x Total Lamp Lumens x Ballast Factor / Input Watts

* AEC = Annual Energy Cost per 1000 lumens (based on 3000 hours use @ \$0.08 KWH).

SUBMITTAL DATA

JOB NAME

TYPE

WATTAGE

VOLTAGE

CATALOG NUMBER

APPROVAL STAMP