

Recessed Type E-Comp  
"Pulse Start" Downlight  
50 to 250 Watt

11" 250W

**HRR-11017**

# THIS PRODUCT IS NO LONGER AVAILABLE

## PLEASE CONSULT

# QUOTATIONS

for the best alternative.

### Features

#### Lamp

- Designed for open rated metal halide E-lamps. See chart below for standard and optional wattages.
- See Option -43 and chart below for lower wattage or HPS availability.

#### Socket

- Vertical. Pulse and open rated.
- Glazed porcelain.
- Nickel-plated brass screw shell. Silicone leads.

#### Reflector

- Self-flanged clear specular Alzak.
- Eleven optional reflector finishes available.

#### Ballast Assembly Specify Voltage

- Whisper Quiet™ pulse start ballast.

150 Watt Class High Pressure Sodium  
voltage reactor for 277 volt.  
175-250 watt: CWA 120 volt and  
Optimizing Class Electronic Reactor for  
volt.

- Capacitor and ignitor supplied.
- Dimming (-39) and electronic (-96) ballasts available. See Options.
- Cool, quiet, long-life. Silicone leads.
- Easy and easy to install on ceilings.
- Resisting drywall.

#### Fuse

Electronic ballast for 120 volt

#### Housing

- Acrylic or polycarbonate luminaire housing.
- Cool: Dissipates heat across entire surface area. Ventilated.

Excess heat is dissipated through  
vents.

- Entire luminaire serviced from below through removable reflector.
- Built-in plaster frame.

#### Outlet Box

- Prewired 14 GA (NEC) galvanized steel, UL listed; with removable insulated cover.
- 1/2" and 3/4" knockouts.

#### Installation

- 27" galvanized hanger bars supplied (2).
- Fully adjustable universal mounting brackets supplied (2).
- Recesses indoor or outdoor in covered locations.

#### UL, C-UL (Canada) Listings

- Wet, damp or dry locations, covered ceilings.
- Through-branch circuit conductors (6 #12).

#### Three Year Limited Warranty

- Complete standard fixture, including ballast.
- 5 year protection.

### Wattage Availability and Cut-Out Dimensions

Catalog No.	Lamp/Base	Standard Wattage		Option -43: Lower Wattage		Ceiling Cut-Out Diameter
		Pulse MH	-24 (HPS)	Pulse MH	-24 (HPS)	
HRR-11017	ED-28/Mog	250	250	150-200	150	12.25"

### Options

#### Sources and Ballasts

- 24 HPS ballast instead. See wattage chart above for available wattages. Specify voltage.
- 39 Electronic dimming ballast instead, for pulse start metal halide. Consult factory for wattage and voltage availability.
- 96 Regulating electronic MH ballast instead. Consult factory for availability in 175W or above.

#### Wattage and Voltage

- 43 Lower wattage: See Option -43 chart above for available lower wattages. Specify voltage.
- 120 120 volt, 60 Hz. ballast.
- 277 277 volt, 60 Hz. ballast.
- 347 347 volt, 60 Hz. ballast. Consult factory for dimming or electronic.
- 97 Other voltage ballast instead. Consult factory.

#### Relays, Lamps (See Chart)

- HL Hi-Lo wiring modification for use with external relay systems (by others). 175 watt or above. CWA ballast only. Specify system.
- LP With lamp. Specify source, wattage, color temperature, and clear or coated. (3700°K standard for metal halide) Consult factory for other color temperatures.

#### Reflectors and Trims (Self-Flanged)

- 16 Champagne Gold specular Alzak reflector. (CP x .93)
- 31 White flange (only) on self-flanged reflector.
- 32 Trim extender. Broadens trim flange O.D. by 1" to cover larger ceiling opening.
- 45 Gasket above reflector flange. Stops dust streaks on ceiling.
- 63 Dune specular Alzak reflector. (CP x .90)
- 69 Wheat specular Alzak reflector. (CP x .88)
- 70 SofTex Clear softly etched reflector. Resists smudges. (CP x .90)

- 71 SofTex Dune softly etched reflector. Resists smudges. (CP x .81)
- 77 SofTex Pewter softly etched reflector. Resists smudges. (CP x .78)
- 90 SofTex Champagne Gold softly etched reflector. Resists smudges. (CP x .84)
- 91 SofTex Wheat softly etched reflector. Resists smudges. (CP x .80)
- 93 Pewter specular Alzak reflector. (CP x .85)
- 94 Custom color reflector. Consult factory.

#### Mounting Options

- 79 Extension collar for up to 2" thick ceilings.
- 85 Ceiling Panel; with recessed fixture hole. Lays-in 2' x 2' grid. White

#### Other Options

- 99 Special modification. Consult factory.

### HRR-11017

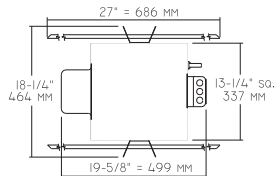

Plan View

#### Cone of Light Key

- Ft.** Distance from fixture
- FC** Footcandles (average)
- Dia.** Circle of light at 50% of FC

\* Dia. (in ft.) shown is where FC value is half the FC at nadir.

**C.U. (Coefficients of Utilization)**  
Tables are available on request.  
Please contact your Kirlin representative.

LIMITED WARRANTY: CATALOGED KIRLIN FIXTURES ARE WARRANTED FREE OF DEFECTS IN WORKMANSHIP OR MATERIAL FOR THREE YEARS FROM DATE OF PURCHASE. INSTALLER TO N.E.C. IN NORMAL USE. Manufacturer at his option will replace or repair, at no charge, any fixture found to be defective in workmanship or material. This warranty is void if the fixture is not installed in accordance with the instructions provided by Kirlin. This warranty is void if the fixture is not installed in accordance with the instructions provided by Kirlin. This warranty is void if the fixture is not installed in accordance with the instructions provided by Kirlin. This warranty is void if the fixture is not installed in accordance with the instructions provided by Kirlin. This warranty is void if the fixture is not installed in accordance with the instructions provided by Kirlin.

### HRR-11017 250W (Plan View B)

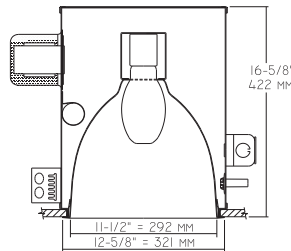

#### (Coated Lamp)

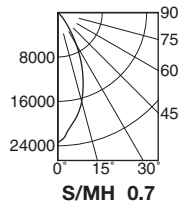

#### Cone of Light\*

Ft.	FC	Dia.
10	234.6	6.9
15	104.3	10.4
20	58.7	13.9
25	37.5	17.3
30	26.1	20.8
35	19.2	24.3

**EFFIC: 63.5%**

**ITL TEST #51687**

\*LER = 46.2 •AEC = \$5.19

	CANDLEPOWER DISTRIBUTION				
	0.0	22.5	45.0	67.5	90.0
<b>0</b>	23463	23463	23463	23463	23463
<b>5</b>	21288	21288	21288	21288	21288
<b>15</b>	16614	16614	16614	16614	16614
<b>25</b>	9986	9986	9986	9986	9986
<b>35</b>	3796	3796	3796	3796	3796
<b>45</b>	825	825	825	825	825
<b>55</b>	54	54	54	54	54
<b>65</b>	9	9	9	9	9
<b>75</b>	0	0	0	0	0
<b>85</b>	0	0	0	0	0
<b>90</b>	0	0	0	0	0

\* LER (Luminaire Efficacy Rating) = Luminaire Effic. x Total Lamp Lumens x Ballast Factor / Input Watts

• AEC = Annual Energy Cost per 1000 lumens (based on 3000 hours use @ \$0.08 KWH).

### SUBMITTAL DATA

JOB NAME

TYPE

WATTAGE

VOLTAGE

CATALOG NUMBER

### APPROVAL STAMP