

Recessed Lensed E-Lamp  
Horizontal Mounting:  
50 to 150 Watt

6" 100W  
8" 150W

**HRR-06071**  
**HRR-08072**

# THIS PRODUCT IS NO LONGER AVAILABLE

## Please consult QUOTATIONS

# for the best alternative.

### Features

#### Lamp

- Designed for medium base metal halide ED-17 lamps. See chart for standard and optional wattages.
- See Option -43 and chart for lower wattage or HPS availability.

#### Socket

- Horizontal. Pulse rated. Glazed porcelain.
- Nickel-plated brass screw shell. Silicone leads.

#### Reflector

- Specular Alzak® aluminum.

#### Trim Assembly

- Seamless tapered black OptiGroove with self-flanged white trim.
- UV absorbing prismatic lens for brightness.
- Optional films and lenses available.

#### Ballast Assembly Specifications

- Pulse rated. Duty cycle: 180 minutes.
- Rated HFF pulse start ballast.
- Class H, high reactance for 120 volt and Options -65, -66; linear reactor for 277 volt.
- Capacitor and ignitor supplied.
- Dimming (-39) and electronic (-96) ballasts available. See Options.
- Dust proof. For new buildings.
- Visible and easily serviced in all ceilings including dry wall.
- Acrylic enameled aluminum.
- Cool. Dissipates heat across entire surface.
- Rustproof. Exceeds 1000 hour ASTM 5% salt spray test.

- Entire luminaire serviced through removable trim assembly.
- Built-in plaster frame.

#### Outlet Box

- Prewired 14 GA (NEC) galvanized steel, UL listed; with removable insulated cover.
- 1/2" and 3/4" knockouts.

#### Installation

- 27" galvanized hanger bars supplied (2).
- Fully adjustable universal mounting brackets supplied (2).
- Recesses indoor or outdoor in covered locations.
- **UL, C-UL (Canada) Listings**
- Wet, damp or dry locations, covered ceilings.
- Through-branch circuit conductors (6 #12).
- **Three Year Limited Warranty**
- Includes standard fixture, including ballast.
- **Thermal Protection**
- Per current NEC

### Wattage Availability and Cut-Out Dimensions

Catalog No.	Lamp/Base	Standard Pulse MH	Wattage -24 (HPS)	Option -43: Lower Wattage Pulse MH	Wattage -24 (HPS)	Max. Standby Wattage (-49-65-66-LS)	Ceiling Cut-Out Diameter
HRR-06071	ED-17/Med	100	100	50-70	35-70	100	6.5"
HRR-08072	ED-17/Med	150	150	50-125	35-100	100	9.0"

### Options

#### Sources and Ballasts

- 24 HPS ballast instead. See wattage chart above for available wattages. Specify voltage.
- 39 Electronic dimming ballast instead, for pulse start metal halide. Consult factory for wattage and voltage availability.
- 96 Regulating electronic MH ballast instead.

#### Wattage and Voltage

- 43 Lower wattage: See Option -43 chart above for available lower wattages. Specify voltage.
- 120 120 volt, 60 Hz. ballast.
- 277 277 volt, 60 Hz. ballast.
- 347 347 volt, 60 Hz. ballast. Consult factory for dimming or electronic.
- 97 Other voltage ballast instead. Consult factory.

#### Relays, Standbys, Lamps (See Chart)

- 49 Extra circuit DCB socket. Do not energize simultaneously with main source. Also see -LS.
- 65 Electronic standby system and DCB socket. Following HID outage, provides immediate light until HID restrikes. Also see -66 and -LS.
- 66 Electronic time delay standby system and DCB socket. Following outage, provides light until HID reaches 70% output. Also see Option -LS.
- LP With lamp. Specify source, wattage, color temperature, and clear or coated. (3700°K standard for metal halide)
- LS With T-4 DCB tungsten halogen standby lamp. Use only with Options -49, -65 or -66.

#### Lenses and Trims

- 32 Trim extender. Broadens trim flange O.D. by 1" to cover larger ceiling opening.
- 40 White grooveless flare trim assembly instead.
- 45 Gasket between trim and ceiling.

- 46 Gasket between trim and lens.
- 94 Custom color trim assembly. Consult factory.
- FR Fresnel tempered lens instead.
- FT Flat white trim instead. With standard C#73 lens or specify optional lens.
- HO Holophane concave lens instead for HRR-08072.

#### Mounting Options

- 79 Extension collar for up to 2" thick ceilings.
- 85 Ceiling Panel; with recessed fixture hole. Lays-in 2' x 2' grid.

#### Other Options

- 99 Special modification. Consult factory.

### HRR-07026

Plan View

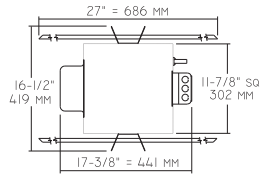

**Cone of Light Key**

- Ft.** Distance from fixture
- FC** Footcandles (average)
- Dia.** Circle of light at 50% of FC
- Dia. (in ft.) shown is where FC value is half the FC at nadir.

**C.U. (Coefficients of Utilization) Tables are available on request. Please contact your Kirlin representative.**

LIMITED WARRANTY: CATALOGED KIRLIN FIXTURES ARE WARRANTED FREE OF DEFECTS IN WORKMANSHIP OR MATERIAL FOR THREE YEARS FROM DATE OF PURCHASE, INSTALLED TO N.E.C. IN NORMAL USE. Manufacturer at his option will replace or repair, at no charge, the fixture or any part thereof, if it is found to be defective in workmanship or material, provided that the purchaser or user has followed the instructions for installation, operation, and maintenance, and that the fixture is not damaged by misuse, abuse, or any other cause. This warranty is void if the fixture is not installed, operated, or maintained in accordance with the instructions. This warranty is void if the fixture is not installed, operated, or maintained in accordance with the instructions. This warranty is void if the fixture is not installed, operated, or maintained in accordance with the instructions.

### HRR-07026 200W

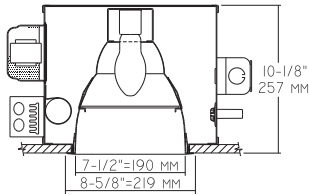

#### HRR-07026 (Coated Lamp)

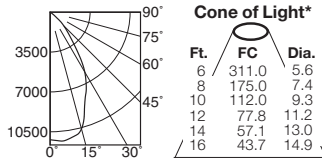

**S/MH 0.9      EFFIC: 58.2%**  
**ITL TEST #51675**  
**\*LER = 47.7    •AEC = \$5.04**

	CANDLEPOWER DISTRIBUTION				
	0.0	22.5	45.0	67.5	90.0
0	11197	11197	11197	11197	11197
5	11358	11358	11358	11358	11358
15	10603	10603	10603	10603	10603
25	7488	7488	7488	7488	7488
35	4083	4083	4083	4083	4083
45	1687	1687	1687	1687	1687
55	211	211	211	211	211
65	97	97	97	97	97
75	0	0	0	0	0
85	0	0	0	0	0
90	0	0	0	0	0

#### HRR-07026-15 (Clear Lamp)

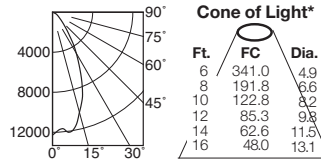

**S/MH 0.8      EFFIC: 52.7%**  
**ITL TEST #51692**  
**\*LER = 45.3    •AEC = \$5.30**

	CANDLEPOWER DISTRIBUTION				
	0.0	22.5	45.0	67.5	90.0
0	12276	12276	12276	12276	12276
5	11676	11676	11676	11676	11676
15	10355	10355	10355	10355	10355
25	6578	6578	6578	6578	6578
35	3135	3135	3135	3135	3135
45	1362	1362	1362	1362	1362
55	690	690	690	690	690
65	332	332	332	332	332
75	12	12	12	12	12
85	0	0	0	0	0
90	0	0	0	0	0

#### HRR-07026-ML (Clear Lamp)

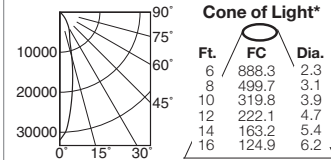

**S/MH 0.4      EFFIC: 56.1%**  
**ITL TEST #51689**  
**\*LER = 48.2    •AEC = \$4.98**

	CANDLEPOWER DISTRIBUTION				
	0.0	22.5	45.0	67.5	90.0
0	31979	31979	31979	31979	31979
5	26645	26645	26645	26645	26645
15	11532	11532	11532	11532	11532
25	5760	5760	5760	5760	5760
35	3129	3129	3129	3129	3129
45	1293	1293	1293	1293	1293
55	420	420	420	420	420
65	222	222	222	222	222
75	15	15	15	15	15
85	2	2	2	2	2
90	0	0	0	0	0

\* LER (Luminaire Efficacy Rating) = Luminaire Effic. x Total Lamp Lumens x Ballast Factor / Input Watts

• AEC = Annual Energy Cost per 1000 lumens (based on 3000 hours use @ \$0.08 KWH).

### SUBMITTAL DATA

### APPROVAL STAMP

JOB NAME

TYPE

WATTAGE

VOLTAGE

CATALOG NUMBER