

CATALOG #	TYPE	
JOB NAME	WATTAGE	VOLTAGE

8" x 8" 1 Triple 42 WATT MAXIMUM

FRS-08102

Type C Square Regressed Lens Downlight
Air Tight Optional

THIS PRODUCT IS NO LONGER AVAILABLE

Features

Lamp

- Designed for one 4-pin triple tube amalgam or compact fluorescent lamp: 42/32/26W triple or 26W quad.
- Ballast: Multi-Wattage/Voltage** Electronic high power factor, thermally protected. For lower wattages: Option -43.
- 120-277 multi-volt; 50/60 Hz. THD < 10%.
- ClickQuick connectors for easy service.
- Cold weather -22°F (-30°C).
- End of lamp life protection circuit. PFI filter.
- Internally fused. Also see Option -FS.

Reflector

- Specular Alzak® aluminum.

Trim Assembly

- Tapered aluminum black OptiGroove with white flange or all white smooth self-flanged trim (Option -40).
- Regressed temperature sensitive trim.

Aluminum Housing

- Acrylic enameled finish. Emission 100-hour UV resistant spray test.
- Lightweight: Minimizes ceiling load.
- Cool operation: Extends component life.

- Embossed aluminum service through aperture.
- Best-in-class plastic trim.
- Air Tight design. See Option -AT.

Outlet Box

- Prewired 14 GA (NEC) galvanized steel, UL listed. 1/2" and 3/4" knockouts.

Installation

- 27" galvanized hanger bars with adjustable mounting brackets for concrete.
- Accessed from above through ceiling.
- Locations.

UL/CSA Listings

- UL Type IC, Dry Location, Class II, Limited Energy.
- UL Type IC, Dry Location, Class II, Limited Energy.
- UL Type IC, Dry Location, Class II, Limited Energy.

- Through-branch conductors (6 #12).
- Pre-wired for 120V/277V.
- Pre-wired for 120V/277V.

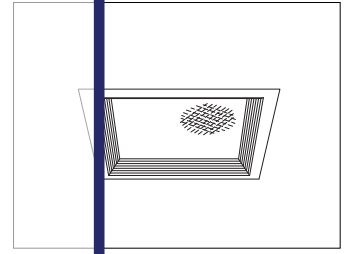

Recessed Square
Regressed Lens
Shallow Plenum
Type IC

Selected Optional Trims:

- White Grooveless Flare Option -40

Please consult **QUOTATIONS** for the best alternative.

Performance at a Glance

FRS-08102

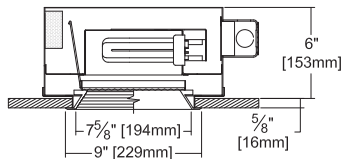

Option -40 Also Shown

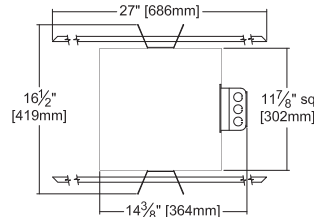

Ceiling Cut-out
8 1/2" Sq.

FRS-08102 (1 Triple 42W)

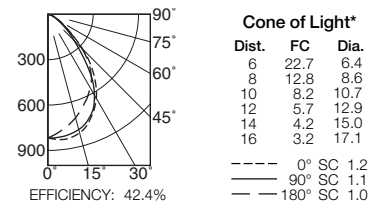

Cone of Light Key

- Ft.** Distance from fixture
- FC** Footcandles (average)
- Dia.** Circle of light at 50% of FC

* Dia. (in ft.) shown is where FC value is half the FC at nadir.

THE KIRLIN COMPANY

3401 EAST JEFFERSON AVENUE • DETROIT, MICHIGAN 48207-4232
(313) 259-6400 • Fax: (313) 259-9409 OR (313) 259-3121 • www.kirlinlighting.com

RENAISSANCE SERIES
COMPACT FLUORESCENT LIGHTING

MAXIMUM WATTAGE

1 Triple 42

CATALOG NUMBER

FRS-08102

DUE TO OUR CONTINUING EFFORT TO IMPROVE PRODUCTS, TECHNICAL INFORMATION IS SUBJECT TO CHANGE WITHOUT NOTICE.

Alzak® is a registered trademark of ALCOA.

Detailed Photometry - Installed Fixture

Photometry from I.T.L., Boulder, CO

FRS-08102 (1 Triple 42)

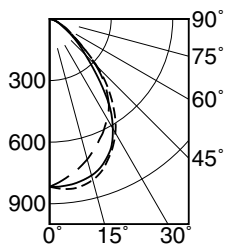

----- 0° SC 1.2
 _____ 90° SC 1.1
 - - - - - 180° SC 1.0

EFFICIENCY : 42.4%

CANDLEPOWER DISTRIBUTION					
	0.0	45.0	90.0	135.0	180.0
0	817	817	817	817	817
5	831	829	816	798	785
15	812	814	789	734	708
25	712	733	702	644	613
35	549	560	502	491	502
45	327	319	247	287	318
55	135	147	116	132	132
65	60	58	51	53	60
75	21	20	23	16	19
85	0	0	0	0	0
90	0	0	0	0	0

COEFFICIENTS OF UTILIZATION							
RF	20						
	80			50			
RC	70	50	30	10	50	30	10
1	47	46	45	43	43	42	41
2	44	42	39	38	39	38	36
3	41	38	35	33	36	34	32
4	38	34	31	29	33	30	28
5	36	31	28	26	30	27	25
6	33	29	26	23	28	25	23
7	31	26	23	21	26	23	21
8	29	24	21	19	24	21	19
9	28	23	20	18	22	19	17
10	26	21	18	16	21	18	16

ITL TEST #45276 *LER=25.4 •AEC=\$9.43

* LER = Luminaire Efficiency Rating

$$LER = \frac{\text{Luminaire Effic.} \times \text{Total Lamp Lumens} \times \text{Ballast Factor}}{\text{Input Watts}}$$

• AEC = Annual Energy Cost per 1000 lumens (based on 3000 hours use @ \$0.08 KWH).

Options

Ballast, Wattage and Voltage

- 39 Installed electronic dimming ballast. Not Type IC listed. Indoor use. 10°C (50°F) minimum start. Specify wattage, voltage and brand.
- 43 Lower wattage: for either 4-pin electronic 18W triple/quad or 13W quad (only). Specify wattage.
- 97 Specify other voltage. Consult factory.
- 98 347 volt, 50/60 Hz. THD < 10%. input. Consult factory.

Emergency Ballast - Specify Voltage¹

Internal (factory installed) ballast, test switch and indicator light. Suitable for damp locations from 0° to 50°C (32° to 122°F) or with Cold Weather

- version (see -CE) -20° to 55°C (-4° to 131°F).
- 73 Internal 1-lamp EM ballast. Specify voltage.
- CE Internal cold weather (-20° to 55°C) 1-lamp EM ballast. Specify voltage.
- HE¹ Internal higher lumen (up to 1250) 1-lamp EM ballast. 13-42W only. Specify voltage.

Lenses and Trims

- 13 Vandal resistant tempered prismatic C#73 spread lens above 1/8" flat polycarbonate.
- 17 .187" prismatic high strength acrylic lens.
- 18 Opal flat glass diffuser.
- 20 White aluminum 1/2" cube egg-crate louver.
- 21 White flat polycarbonate diffuser.
- 32 White oversize trim extender. Specify size.
- 40 White grooveless flare trim. (CP x 1.10)
- 45 Gasket between ceiling and trim flange.

- 46 Gasket between trim and lens.
- 79 Extension collar for ceilings up to 2" thick.
- 94 Custom color/finish. Specify. Consult factory.
- CF High temperature color filter. Specify color.
- UV UV filter. Consult factory.

Other

- 99 Special modification. Consult factory.
- AT Air tight with Type IC. Meets / exceeds ASTM E283 restricted airflow of 2 CFM maximum.
- FS Additional in-line fuse. Not available with Option -98 (347V).
- LE With 4-pin electronic lamp. 3500°K standard. 82 CRI and 12,000 hour life. Specify wattage, style and color temperature.

¹ Visit www.kirlinlighting.com for most current performance / specifications.

SUBMITTAL DATA

APPROVAL STAMP

JOB NAME

TYPE

WATTAGE

VOLTAGE

CATALOG NUMBER

LIMITED WARRANTY: CATALOGED KIRLIN FIXTURES ARE WARRANTED FREE OF DEFECTS IN WORKMANSHIP OR MATERIAL FOR THREE YEARS FROM DATE OF PURCHASE. INSTALLER TO N.E.C. IN NORMAL USE. Manufacturer at his option will replace or repair such fixture or refund the purchase price on presentation of proof of defect in workmanship or material within three years of original shipment. Liability of manufacturer is limited to the foregoing, and manufacturer shall not be liable for any other damages, direct or indirect, sustained or suffered by purchaser or any person. This warranty is supplied to the buyer in place of all other warranties, expressed or implied. Seller does not warrant as to merchantability or fitness for a particular use, nor will any oral statement constitute a warranty or amend this specific warranty. Abnormal use, abuse of the fixture, improper installation, repair, or modification of the fixture without prior written authorization from the manufacturer will render the warranty void.