

CATALOG #	TYPE	
JOB NAME	WATTAGE	VOLTAGE

Symphony Remote Driver Series

Lensed 6" Wall Wash • LED

Up to 60,000 Hour Rated Life (L70) • Wet Location
LM-80 Qualified • LM-79 Certified Photometry

SRR-06616



Specifications

Delivered System Performance

- Nominal Lumens: **Must Specify**
- Type IC** **Non-IC**
- 2500L** **-5000L**
- 4000L**

- Color temperature: 3500°K standard; Optional: -27K, -30K, -41K or -50K
- CRI: 80+ standard; Optional: -HC (90+)
- 60,000 hour rated life (L70)
- Fully sustainable: removable for servicing
- Center beam optics positioned at 25°

Thermal Management System

- All aluminum heat sink, components and housing maximize cool operation and long life while minimizing maintenance

Remote Power Supply Required

- Kirlin offers two types of remote power supply cabinets (see pages 4-6 for more details):
 - Symphony Cabinet:**
 - Surface-mounted cabinets (18" x 24" x 4-1/2")
 - Supports up to 8 drivers
 - For 0-10V and DMX applications (see page 4 for more details)
 - Remote Mini-Cabinet:**
 - Plenum-rated mini-cabinets (4-3/8" x 20-1/4" x 2-3/4")
 - Supports up to 2 drivers
 - For 0-10V and DMX applications (see page 5-6 for more details)
- The **Symphony Configurator** can help determine the necessary component

SmartPower™ Battery Backup

- EMI-21220** for emergency power
- See specification sheet; order separately

Trim

- Clear specular aluminum trim
- Self-flanged, low glare angle-cut cone; prismatic spread lens above
- Optional colors and finishes available

Acrylic Enameled Aluminum Housing

- Rustproof and corrosion: Exceeds 1000 hour ASTM 5% salt spray test
- Shallow depth fits restricted plenums
- Cool operation: Extends life of all components
- Fully sustainable: Entire luminaire, including LED light engine, easily visible and serviced through aperture
- Built-in plaster flange

Outlet Box

- UL listed J-box with insulated removable cover. Prewired 14 GA (NEC) with 1/2" and 3/4" knockouts

Installation

- Requires minimum 16 AWG shielded twisted pair wire from driver to fixtures
- Maximum cable run from driver to fixture is 250'**
- Recesses in ceilings up to 1 1/8" thick
- Compatible with fire rated enclosures (by others)
- 27" galvanized hanger bars with adjustable mounting brackets (2) supplied

UL, C-UL (Canada) Listings

- Wet, damp, dry locations, covered ceilings
- 2500L (only): Type IC - for direct contact with insulation

FCC Compliance

- FCC Part 15 certified for EMI/RFI emissions

FIVE YEAR Limited Warranty

- Complete standard fixture (must be used with SYM-CABNT, SYM-DMXPS or REM-SWCAB)

Maintenance and Future-Proofing

- M1 maintenance level standard- Phillips head screwdriver, and/or a basic wrench needed
- Lighthead replaceable through the aperture of the fixture with quick-connections, no soldering required
- Backed by Kirlin's **25-Year Legacy Support Guarantee**

Made in the USA
BABA Compliant

FCC Part 15
Certified

UL Listed
Wet, Damp, Dry

Maintenance
Level M1

Available Maintenance Levels

Level	Option	Tools Required to Service LED Module
	Standard	<ul style="list-style-type: none"> Phillips head screwdriver, and/or a basic wrench needed

Dimensions

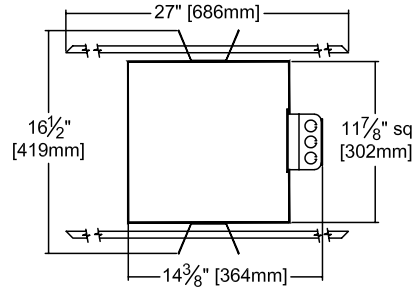
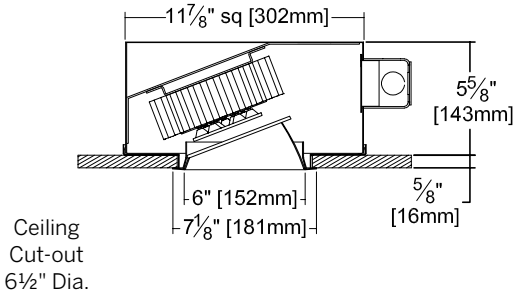

Photometry - Installed Complete Fixture

Photometry from I.T.L., Boulder, CO

LM-79 IES Certified Photometry from Independent Lab

-5000L Performance

Lumens: **4141**
 LPW: **72**
 Efficiency: **69.6%**
 ITL Test: **87512**

WALL > - - - - 0°
 - - - - 90°
 - - - - 180°

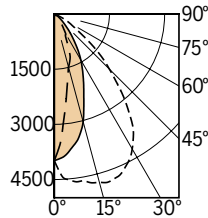

Total System Watts 57.4

DISTANCE FROM CEILING IN FEET	SINGLE FIXTURE				MULTIPLE FIXTURES						
	1'	2'	3'	4'	2' CENTERS	3' CENTERS	3' CENTERS	3' CENTERS			
	FIXTURE INSTALLED 2' FROM WALL Footcandle Distribution on Wall Surface										
1	50.8	22.8	4.9	1.9	1.2	67.6	67.8	67.7	57.0	26.0	56.8
2	189.0	102.0	24.6	6.2	2.2	246.0	246.0	246.0	205.0	109.0	205.0
3	167.0	118.0	43.6	12.7	4.4	265.0	265.0	265.0	196.0	159.0	196.0
4	103.0	83.1	45.4	17.9	6.6	212.0	212.0	212.0	141.0	140.0	141.0
5	62.3	53.8	35.4	18.8	8.4	157.0	157.0	157.0	104.0	103.0	104.0
6	39.6	35.3	26.0	16.4	9.0	118.0	119.0	119.0	78.9	77.2	78.9
7	26.7	24.5	19.2	13.5	8.6	92.0	92.8	92.8	61.2	60.7	61.2
8	19.4	18.1	14.9	11.2	7.8	75.8	76.8	76.7	50.0	50.5	49.9
9	15.5	14.6	12.4	9.8	7.2	66.7	67.0	67.0	43.3	44.1	43.3

-4000L Performance

Lumens: **3330**
 LPW: **78**
 Efficiency: **69.8%**
 ITL Test: **88285**

WALL > - - - - 0°
 - - - - 90°
 - - - - 180°

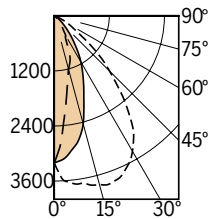

Total System Watts 42.9

DISTANCE FROM CEILING IN FEET	SINGLE FIXTURE				MULTIPLE FIXTURES						
	1'	2'	3'	4'	2' CENTERS	3' CENTERS	3' CENTERS	3' CENTERS			
	FIXTURE INSTALLED 2' FROM WALL Footcandle Distribution on Wall Surface										
1	40.9	18.3	3.9	1.5	1.0	54.4	54.6	54.5	45.9	21.0	45.7
2	152.0	81.7	19.8	5.0	1.8	198.0	198.0	198.0	165.0	87.6	165.0
3	135.0	95.2	35.0	10.2	3.5	213.0	213.0	213.0	158.0	128.0	158.0
4	82.4	66.8	36.5	14.4	5.3	170.0	171.0	170.0	114.0	113.0	114.0
5	50.1	43.2	28.5	15.1	6.8	126.0	126.0	126.0	83.8	83.1	83.7
6	31.8	28.4	20.9	13.1	7.2	95.2	95.3	95.3	63.5	62.1	63.4
7	21.4	19.7	15.4	10.9	6.9	74.0	74.7	74.6	49.2	48.8	49.2
8	15.6	14.5	12.0	9.0	6.3	60.9	61.7	61.7	40.2	40.6	40.2
9	12.4	11.7	10.0	7.9	5.8	53.7	53.9	53.8	34.8	35.4	34.8

-2500L Performance

Lumens: **2772**
 LPW: **79**
 Efficiency: **74.6%**
 ITL Test: **87769**

WALL > - - - - 0°
 - - - - 90°
 - - - - 180°

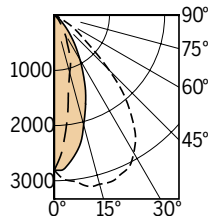

Total System Watts 35.2

DISTANCE FROM CEILING IN FEET	SINGLE FIXTURE				MULTIPLE FIXTURES						
	1'	2'	3'	4'	2' CENTERS	3' CENTERS	3' CENTERS	3' CENTERS			
	FIXTURE INSTALLED 2' FROM WALL Footcandle Distribution on Wall Surface										
1	23.6	11.5	2.9	1.3	0.8	34.0	34.1	34.1	27.7	13.5	27.6
2	124.0	62.7	13.8	3.6	1.4	157.0	157.0	157.0	134.0	62.7	134.0
3	114.0	81.0	28.2	7.8	2.7	178.0	178.0	178.0	132.0	107.0	132.0
4	69.4	56.7	29.6	11.4	4.0	140.0	140.0	140.0	94.2	94.2	94.2
5	41.4	37.2	24.2	12.1	5.3	105.0	105.0	105.0	68.5	70.6	68.5
6	26.4	24.2	18.1	10.8	5.8	79.8	79.9	79.9	52.2	53.5	52.2
7	17.8	16.8	13.5	9.3	5.6	62.3	62.4	62.4	41.2	41.8	41.2
8	13.1	12.4	10.6	7.9	5.3	51.8	52.0	51.9	34.1	34.5	34.1
9	10.5	10.0	8.8	6.9	4.9	45.7	45.8	45.8	29.7	30.1	29.7

LED manufacturers maintain a tolerance of +/-7% on flux (lumens) and power (electrical) measurements.

LIMITED WARRANTY: KIRLIN LIGHTING FIXTURES ARE WARRANTED FREE OF DEFECTS IN WORKMANSHIP OR MATERIAL FOR THE DATE OF PURCHASE. INSTALLATION, USE, MAINTENANCE, REPAIR, OR RETURN OF THE FIXTURE WITHOUT PRIOR WRITTEN AUTHORIZATION FROM THE MANUFACTURER WILL VOID THE WARRANTY. THE PURCHASE PRICE OR REPRESENTATION OF THE PURCHASE AND DELIVERY OF THE FIXTURE AT THE OFFICES OF THE MANUFACTURER WITHIN THE UNITED STATES OF AMERICA IS LIMITED TO THE FOREGOING AND MANUFACTURER SHALL NOT BE LIABLE FOR ANY OTHER DAMAGES, DIRECT OR INDIRECT, SUSTAINED OR SUFFERED BY THE PURCHASER OR ANY PERSON. THIS WARRANTY IS APPLIED TO THE BUYER IN PLACE OF ALL OTHER WARRANTIES, EXPRESSED OR IMPLIED. SELLER DOES NOT WARRANT AS TO MERCHANTABILITY OR FITNESS FOR A PARTICULAR USE, NOR WILL ANY ORAL STATEMENT CONSTITUTE A WARRANTY OR AMEND THIS SPECIFIC WARRANTY. ABNORMAL USE, ABUSE OF THE FIXTURE, IMPROPER INSTALLATION, OR REPAIR OR MODIFICATION OF THE FIXTURE WITHOUT PRIOR WRITTEN AUTHORIZATION FROM THE MANUFACTURER WILL VOID THE WARRANTY.

Options and Ordering Configuration

(Example: SRR-06616-6500L-30K-45)

Must Specify		Optional			
Model	Lumens	Dimming	Color Temp. (CCT)	Lens & Trim	Other Options
SRR-06616					
	Non-IC -5000L -4000L Type IC -2500L	-010V: 0-10V Dimming -DMX: DMX-RDM Dimming	(Blank): 3500°K -27K: 2700°K instead -30K: 3000°K instead -41K: 4000°K instead -50K: 5000°K instead -HC: 90+ CRI instead	(Blank): Clear specular trim; lens above -30T: White enamel (complete trim) -30F: White enamel (flange only) -32: White oversize trim ring; specify O.D. -37F: Dark bronze enamel (flange only) -38F: Black enamel (flange only) -45: Gasket between trim flange and ceiling -70T: Clear semi-specular SofTex™ (complete trim) -94: Custom color/finish; specify; consult factory	(Blank): None -99: Special modification; consult factory -AT: Air tight version; meets ASTM E283 restricted airflow of 2 CFM maximum -RH: Residential mounting hardware instead. Suitable for wood joist ceilings with spacing from 14 1/8" to 25 7/8" with 5/8" vertical adjustability -SH: Sealed housing and junction box for -6500L or -5000L; see Option -AT for use with -2500L

Dimensions

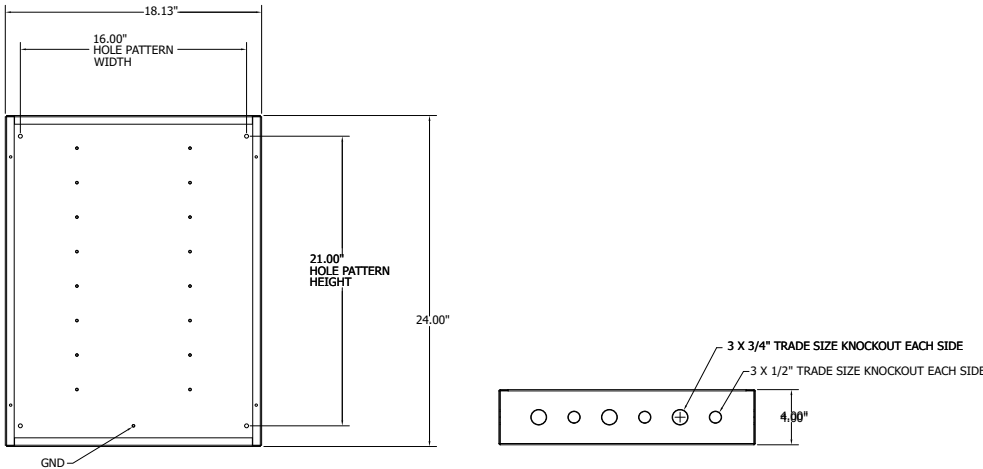

Cabinet Features

- Each cabinet can accommodate up to 8 0-10V driver modules or up to 8 channels of DMX output
- Drivers can be mounted up to 250' away from fixtures
- Symphony cabinets are surface-mounted cabinets
- Low-voltage cabling from driver to fixture(s)

Symphony Driver Modules: Used with 0-10V Dimming

Fully Digital Controlled Power Source for LED Luminaires

Mounted in Kirlin's **SYM-CABNT**

The **Symphony Configurator** can help determine the necessary components.



Lumens	Driver Module	Maximum Capacity	Fixture Load Examples
-2500L	DVR-1400A	Qty 1: 2500L Luminaires	• Qty 1: SRR-06616-2500L
	DVR-1400B	Up to Qty 2: 2500L Luminaires	• Qty 1: SRR-06616-2500L • Qty 2: SRR-06616-2500L • Qty 1: SRR-06616-2500L and Qty 1: SRR-06610-2500L
-4000L	DVR-1050A	Qty 1: 4000L Luminaires	• Qty 1: SRR-06616-4000L
	DVR-1050C*	Qty 2: 4000L Luminaires, 1 per LED output	• Qty 2: SRR-06616-2500L • Qty 1: SRR-06616-4000L and Qty 1: SRR-06610-4000L
-5000L	DVR-1400B	Qty 1: 5000L Luminaires	• Qty 1: SRR-06616-5000L

* 100W DVR-XXXXC driver modules have 2 LED outputs each.

Symphony DMX Power Supplies: Used with DMX Control

Pre-wired Symphony DMX power supplies (**SYM-DMXPS**) have a maximum of 8 channels each.

Each channel is pre-wired for 1400mA and 1050mA output. Ensure appropriate current is selected when wiring.

The **Symphony Configurator** can help determine the necessary components.

Lumens	LED Channel Output	
	1400mA	1050mA
-1500L Luminaire	Up to Qty 2 fixtures in series per channel	
-2500L Luminaire	1 fixture per channel	
-4000L Luminaire	1 fixture per channel	
-5000L Luminaire	2 channels per fixture	
-6500L Luminaire	2 channels per fixture	

Dimensions

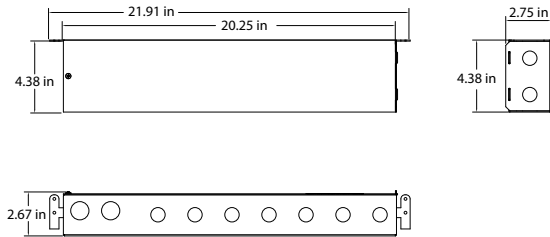

REM-SWCAB Features

- Drivers can be mounted up to 250' away from fixtures
- Remote mini-cabinets are plenum rated and can be mounted to the ceiling grid
- Low-voltage cabling from driver to fixture(s)
- 1/2" and 3/4" knockouts

50W and 75W Drivers Exact dimensions of drivers inside the box may vary based on options chosen.

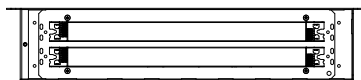

100W Drivers

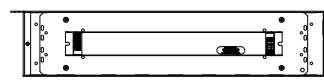

0-10V Remote Mini-Cabinet Options and Ordering Configuration

(Example: REM-SWCAB-1400B-2-D2-EMI)

Must Specify				Optional
Model	Driver Current	Driver Count	Dimming	Other Options
REM-SWCAB				
	50 Watt Drivers -1050A: 1050mA 50W driver; powers (1) 4000L fixture -1400A: 1400mA 50W driver; powers (1) 2500L fixture 75 Watt Drivers -1400B: 1400mA 75W driver; powers (2) 2500L fixtures OR (1) 5000L fixture 100 Watt Drivers -1050C: 1050mA 100W driver; powers (2) 4000L fixtures	-1: 1 driver -2: 2 drivers; N/A on -1400C driver option	-D2: 0-10V 0.1% dim	(Blank): None -E15: Remote emergency micro-inverter: 50W max load; 90+ minutes run time -EMI: Remote emergency mini-inverter: 125W max load; 90+ minutes run time

Lumens	Remote Mini-Cabinet	Driver Wattage	Maximum Capacity	
			1 Driver in REM Cabinet	2 Drivers in REM Cabinet
-2500L	REM-SWCAB-1400A	50W	Qty 1: 2500L Luminaire	Qty 2: 2500L Luminaires, (1 per driver)
	REM-SWCAB-1400B	75W	Qty 2: 2500L Luminaires, wired in series	Qty 4: 2500L Luminaires, (2 per driver, wired in series)
-4000L	REM-SWCAB-1050A	50W	Qty 1: 4000L Luminaire	Qty 2: 4000L Luminaires, (1 per driver)
	REM-SWCAB-1050C*	100W	Qty 2: 4000L Luminaires, 1 per LED output	N/A
-5000L	REM-SWCAB-1400B	75W	Qty 1: 5000L Luminaire	Qty 2: 5000L Luminaires, (1 per driver)

* 100W XXXXC remote drivers have 2 LED outputs each

See next page for DMX Remote Mini-Cabinet Options and Ordering Configuration

DMX Remote Mini-Cabinet Options and Ordering Configuration

(Example: REM-SWCAB-DMX2C-2-16B-EMI)

Must Specify				Optional
Model	Driver Current	Driver Count	Dimming Resolution	Other Options
REM-SWCAB				
	50 Watt Drivers -DMX2C: 50W driver with two outputs, programmed to 1400mA and 1050mA	-1: 1 driver -2: 2 drivers	(Blank): 8-bit DMX-RDM Dimming to 0.1% -16B: 16-bit DMX-RDM Dimming to 0.1%	(Blank): None -EI5: Remote emergency micro-inverter: 50W max load; 90+ minutes run time -EMI: Remote emergency mini-inverter: 125W max load; 90+ minutes run time

Lumens	Remote Mini-Cabinet	Selected Output	Driver Wattage	Maximum Capacity	
				1 Driver in REM Cabinet	2 Drivers in REM Cabinet
-2500L	REM-SWCAB-DMX2C	1400mA	50W	Qty 1: 2500L Luminaire	Qty 2: 2500L Luminaires, (1 per driver)
-4000L	REM-SWCAB-DMX2C	1050mA	50W	Qty 1: 4000L Luminaire	Qty 2: 4000L Luminaires, (1 per driver)
-5000L	REM-SWCAB-DMX2C	1400mA	50W	Qty 0.5: 5000L Luminaire, (uses 2 drivers per fixture)	Qty 1: 5000L Luminaire, (uses 2 drivers per fixture)