

CATALOG #	TYPE	
JOB NAME	WATTAGE	VOLTAGE

# Symphony Remote Driver Series

Open Appearance 6" Adjustable • LED

Up to 60,000 Hour Rated Life (L70) • Wet Location

LM-80 Qualified • LM-79 Certified Photometry

## SRR-06610

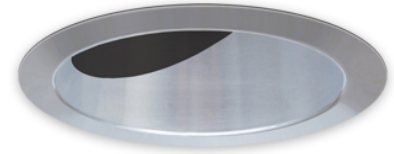

### Specifications

#### Delivered System Performance

- Nominal Lumens: **Must Specify**

<b>Type IC</b>	<b>Non-IC</b>
<b>-2500L</b>	<b>-5000L</b>
	<b>-4000L</b>

- Distributions: NFL standard; Optional: -SPT or -MFL
- Color temperature: 3500°K standard; Optional: -27K, -30K, -41K or -50K
- CRI: 80+ standard; Optional: -HC (90+)
- 60,000 hour rated life (L70)
- Fully sustainable: removable for servicing

#### Center Beam Optics

- Tilts up to 35° and locks in place
- Rotates full 360° and locks in place
- Accommodates sloped ceilings up to 35°

#### Thermal Management System

- All aluminum heat sink, components and housing maximize cool operation and long life while minimizing maintenance

#### Remote Power Supply Required

- Kirlin offers two types of remote power supply cabinets (see pages 5-7 for more details):
  - Symphony Cabinet:**
    - Surface-mounted cabinets (18" x 24" x 4-1/2")
    - Supports up to 8 drivers
    - For 0-10V and DMX applications (see page 5 for more details)
  - Remote Mini-Cabinet:**
    - Plenum-rated mini-cabinets (4-3/8" x 20-1/4" x 2-3/4")
    - Supports up to 2 drivers
    - For 0-10V and DMX applications (see page 6-7 for more details)
- The [Symphony Configurator](#) can help determine the necessary components

#### SmartPower™ Battery Backup

- EMI-21220** for emergency power
- See specification sheet; order separately

#### Trim

- Clear specular aluminum trim
- Self-flanged, low glare angle-cut cone; tempered glass lens above
- Optional colors and finishes available

#### Acrylic Enameled Aluminum Housing

- Rustproof and corrosion: Exceeds 1000 hour ASTM 5% salt spray test
- Shallow depth fits restricted plenums
- Cool operation: Extends life of all components
- Fully sustainable: Entire luminaire, including LED light engine, easily visible and serviced through aperture
- Built-in plaster flange

#### Outlet Box

- UL listed J-box with insulated removable cover; Prewired 14 GA (NEC) with 1/2" and 3/4" knockouts

#### Installation

- Requires minimum 16 AWG shielded twisted pair wire from driver to fixtures
- Maximum cable run from driver to fixture is 250'**
- Recesses in ceilings up to 1 1/8" thick
- Compatible with fire rated enclosures (by others)
- 27" galvanized hanger bars with adjustable mounting brackets (2) supplied

#### UL, C-UL (Canada) Listings

- Wet, damp, dry locations, covered ceilings
- 2500L (only): Type IC - for direct contact with insulation

#### FCC Compliance

- FCC Part 15 certified for EMI/RFI emissions

#### FIVE YEAR Limited Warranty

- Complete standard fixture (must be used with SYM-CABNT, SYM-DMXPS or REM-SWCAB)

#### Maintenance and Future-Proofing

- M1 maintenance level standard- Phillips head screwdriver, and/or a basic wrench needed
- Lighthead replaceable through the aperture of the fixture with quick-connections, no soldering required
- Backed by Kirlin's **25-Year Legacy Support Guarantee**

Made in the USA  
BABA Compliant

FCC Part 15  
Certified

UL Listed  
Wet, Damp, Dry

Maintenance  
Level M1

## Available Maintenance Levels

Level	Option	Tools Required to Service LED Module
	Standard	<ul style="list-style-type: none"> <li>Phillips head screwdriver, and/or a basic wrench needed</li> </ul>

## Options and Ordering Configuration

(Example: SRR-06610-6500L-30K-SPT)

Must Specify		Optional				
Model	Lumens	Dimming	Color Temp. (CCT)	Distribution	Lens & Trim	Other Options
SRR-06610						
	<b>Non-IC</b> -5000L -4000L <b>Type IC</b> -2500L	<b>-010V:</b> 0-10V Dimming  <b>-DMX:</b> DMX-RDM Dimming	<b>(Blank):</b> 3500°K <b>-27K:</b> 2700°K instead <b>-30K:</b> 3000°K instead <b>-41K:</b> 4000°K instead <b>-50K:</b> 5000°K instead <b>-HC:</b> 90+ CRI instead	<b>(Blank):</b> NFL <b>-MFL:</b> Medium flood distribution <b>-SPT:</b> Spot distribution	<b>(Blank):</b> Clear specular trim; lens above <b>-30T:</b> White enamel (complete trim) <b>-30F:</b> White enamel (flange only) <b>-32:</b> White oversize trim ring; specify O.D. <b>-37F:</b> Dark bronze enamel (flange only) <b>-38F:</b> Black enamel (flange only) <b>-45:</b> Gasket between trim flange and ceiling <b>-70T:</b> Clear semi-specular Softex™ (complete trim) <b>-94:</b> Custom color/finish; specify; consult factory <b>-DL:</b> Downlight version instead	<b>(Blank):</b> None <b>-99:</b> Special modification; consult factory <b>-AT:</b> Air tight version; meets ASTM E283 restricted airflow of 2 CFM maximum <b>-RH:</b> Residential mounting hardware instead; suitable for wood joist ceilings with spacing from 14 1/8" to 25 7/8" with 5/8" vertical adjustability <b>-SH:</b> Sealed housing and junction box for -6500L or -5000L; see Option -AT for use with -2500L <b>-TA:</b> Top Access for servicing from above ceiling

# Dimensions

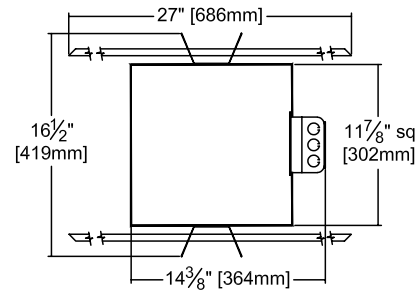
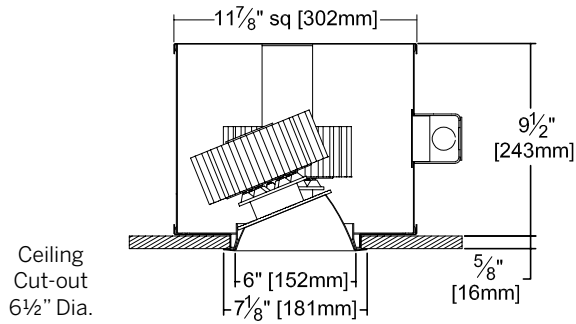

# Photometry - Installed Complete Fixture

Photometry from I.T.L., Boulder, CO

LM-79 IES Certified Photometry from Independent Lab

## -5000L STANDARD (NFL)

Lumens: 4413  
 Beam: ~35°  
 SC: 0.6  
 LPW: 77  
 Efficiency: 74.2%  
 ITL Test: 87784

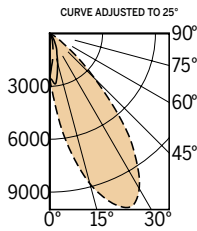

Total System Watts 57.2

CANDLEPOWER DISTRIBUTION					
	0.0	45.0	90.0	135.0	180.0
0	2515	2515	2515	2515	2515
5	4351	3844	2831	1985	1662
15	8831	5316	1752	843	674
25	10855	4621	905	384	283
35	8451	2560	381	117	69
45	3631	885	116	30	17
55	815	251	25	3	1
65	129	40	5	2	0
75	9	4	1	0	0
85	0	0	0	0	0
90	0	0	0	0	0

## -5000L Option -SPT

Lumens: 4359  
 Beam: ~16°  
 SC: 0.3  
 LPW: 77  
 Efficiency: 73.3%  
 ITL Test: 87509

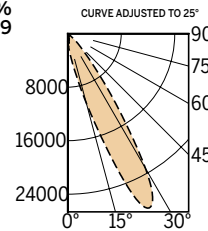

Total System Watts 57.0

CANDLEPOWER DISTRIBUTION					
	0.0	45.0	90.0	135.0	180.0
0	1135	1135	1135	1135	1135
5	2355	2060	1392	992	685
15	10723	4106	850	444	398
25	28756	3483	476	223	185
35	11771	1470	212	75	51
45	2411	432	67	14	11
55	384	161	11	1	0
65	91	13	1	0	0
75	3	1	0	0	0
85	0	0	0	0	0
90	0	0	0	0	0

## -5000L Option -MFL

Lumens: 4345  
 Beam: ~47°  
 SC: 0.8  
 LPW: 76  
 Efficiency: 73.1%  
 ITL Test: 87510

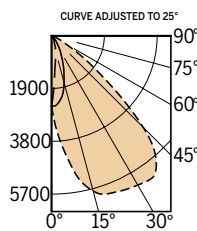

Total System Watts 57.0

CANDLEPOWER DISTRIBUTION					
	0.0	45.0	90.0	135.0	180.0
0	2536	2536	2536	2536	2536
5	3866	3499	2462	1683	1323
15	5786	5002	1742	664	506
25	6133	5081	886	290	230
35	6273	3197	374	132	91
45	4672	1243	141	42	21
55	1466	386	48	7	2
65	300	95	8	0	0
75	28	9	0	0	0
85	0	0	0	0	0
90	0	0	0	0	0

See following page for -4000L and -2500L performance

LED manufacturers maintain a tolerance of +/-7% on flux (lumens) and power (electrical) measurements.

LIMITED WARRANTY: CATALOGED KIRLIN FIXTURES ARE WARRANTED FREE OF DEFECTS IN WORKMANSHIP OR MATERIAL FOR ONE YEAR FROM DATE OF PURCHASE. INSTALLED TO N.E.C. / IN-NORMAL USE. Manufacturer at the option will replace or repair such fixture or refund the purchase price on presentation of proof of purchase and defective fixture at the office of manufacturer within the years of original shipment. Liability of manufacturer is limited to the foregoing and manufacturer shall not be liable for any other damages, direct or indirect, sustained or suffered by purchaser or any person. This warranty is applied to the buyer in place of all other warranties, expressed or implied. Seller does not warrant as to merchantability or fitness for a particular use, nor will any oral statement constitute a warranty or amend this specific warranty. Abnormal use, abuse of the fixture, improper installation, or repair or modification of the fixture without prior written authorization from the manufacturer will render the warranty void.

**Detailed Photometry - Installed Fixture**

Photometry from I.T.L., Boulder, CO

**SRR-06610-4000L PERFORMANCE**

**-4000L STANDARD (NFL)**

Lumens: 3548  
Beam: ~35°  
SC: 0.5  
LPW: 83  
Efficiency: 74.4%  
ITL Test: 88279

Total System Watts 42.7

CANDLEPOWER DISTRIBUTION					
	0.0	45.0	90.0	135.0	180.0
0	2022	2022	2022	2022	2022
5	3498	3091	2276	1596	1336
15	7100	4274	1409	678	542
25	8727	3715	728	309	228
35	6795	2058	306	94	55
45	2919	712	93	24	14
55	655	202	20	2	1
65	104	32	4	2	0
75	7	3	1	0	0
85	0	0	0	0	0
90	0	0	0	0	0

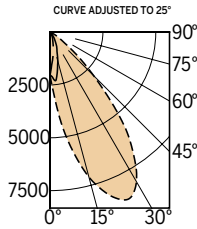

**SRR-06610-2500L PERFORMANCE**

**-2500L STANDARD (NFL)**

Lumens: 2732  
Beam: ~34°  
SC: 0.6  
LPW: 78  
Efficiency: 73.5%  
ITL Test: 88094

Total System Watts 35.2

CANDLEPOWER DISTRIBUTION					
	0.0	22.5	45.0	67.5	90.0
0	1579	1579	1579	1579	1579
5	2462	2129	1578	1256	1177
15	5117	3210	1266	590	453
25	6470	2772	622	268	198
35	5038	1648	269	76	44
45	2264	600	88	17	13
55	559	164	14	1	1
65	89	21	2	1	0
75	5	2	0	0	0
85	0	0	0	0	0
90	0	0	0	0	0

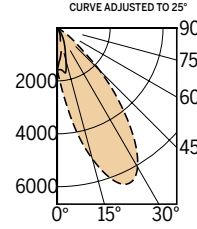

**-4000L Option -SPT**

Lumens: 3504  
Beam: ~17°  
SC: 0.3  
LPW: 82  
Efficiency: 73.5%  
ITL Test: 88280

Total System Watts 42.6

CANDLEPOWER DISTRIBUTION					
	0.0	45.0	90.0	135.0	180.0
0	913	913	913	913	913
5	1893	1656	1119	798	551
15	8621	3301	683	357	320
25	23120	2800	383	179	149
35	9464	1182	170	60	41
45	1938	347	54	11	9
55	309	129	9	1	0
65	73	10	1	0	0
75	2	1	0	0	0
85	0	0	0	0	0
90	0	0	0	0	0

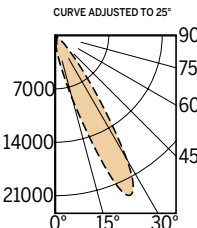

**-2500L Option -SPT**

Lumens: 3008  
Beam: ~16°  
SC: 0.3  
LPW: 86  
Efficiency: 80.9%  
ITL Test: 87766

Total System Watts 35.1

CANDLEPOWER DISTRIBUTION					
	0.0	22.5	45.0	67.5	90.0
0	638	638	638	638	638
5	1289	1052	689	464	440
15	7940	2048	646	260	213
25	23864	1730	314	136	112
35	9013	812	127	39	28
45	1382	228	38	4	5
55	215	58	1	0	0
65	28	3	0	0	0
75	1	1	0	0	0
85	0	0	0	0	0
90	0	0	0	0	0

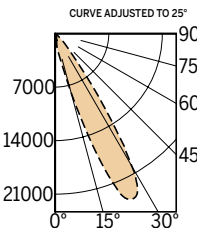

**-4000L Option -MFL**

Lumens: 3493  
Beam: ~47°  
SC: 0.8  
LPW: 82  
Efficiency: 73.3%  
ITL Test: 88281

Total System Watts 42.6

CANDLEPOWER DISTRIBUTION					
	0.0	45.0	90.0	135.0	180.0
0	2039	2039	2039	2039	2039
5	3108	2813	1979	1353	1064
15	4652	4022	1401	534	407
25	4931	4085	712	233	185
35	5043	2570	301	106	73
45	3756	999	113	34	17
55	1179	310	39	6	2
65	241	76	6	0	0
75	23	7	0	0	0
85	0	0	0	0	0
90	0	0	0	0	0

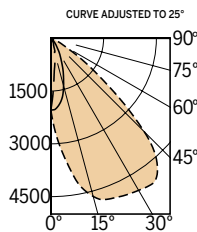

**-2500L Option -MFL**

Lumens: 2997  
Beam: ~45°  
SC: 0.8  
LPW: 85  
Efficiency: 80.6%  
ITL Test: 87767

Total System Watts 35.1

CANDLEPOWER DISTRIBUTION					
	0.0	22.5	45.0	67.5	90.0
0	1679	1679	1679	1679	1679
5	2889	2497	1646	1036	854
15	4253	4036	1307	617	464
25	4219	3861	580	250	207
35	4477	2115	274	105	82
45	2982	697	90	33	21
55	610	194	29	7	3
65	98	42	3	0	0
75	6	2	0	0	0
85	0	0	0	0	0
90	0	0	0	0	0

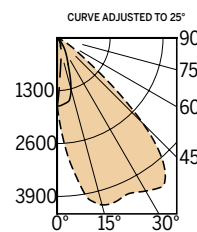

LED manufacturers maintain a tolerance of +/-7% on flux (lumens) and power (electrical) measurements.

LIMITED WARRANTY: CATALOGED KIRLIN FIXTURES ARE WARRANTED FREE OF DEFECTS IN WORKMANSHIP OR MATERIAL FOR FIVE YEARS FROM DATE OF PURCHASE. INSTALLED TO N.E.C. IN NORMAL USE. Manufacturer at his option will replace or repair such fixture or refund the purchase price on presentation of proof of purchase and defective fixture at the office of manufacturer within five years of original date of shipment. Liability of manufacturer is limited to the foregoing, and manufacturer shall not be liable for any other damages, direct or indirect, sustained or suffered by purchaser or any person. This warranty is void where prohibited by law. Seller does not warrant as to merchantability or fitness for a particular use, nor will any oral statement constitute a warranty or amend this specific warranty. Abnormal use, abuse of the fixture, improper installation, or repair, or modification of the fixture without prior written authorization from the manufacturer will render the warranty void.

## Dimensions

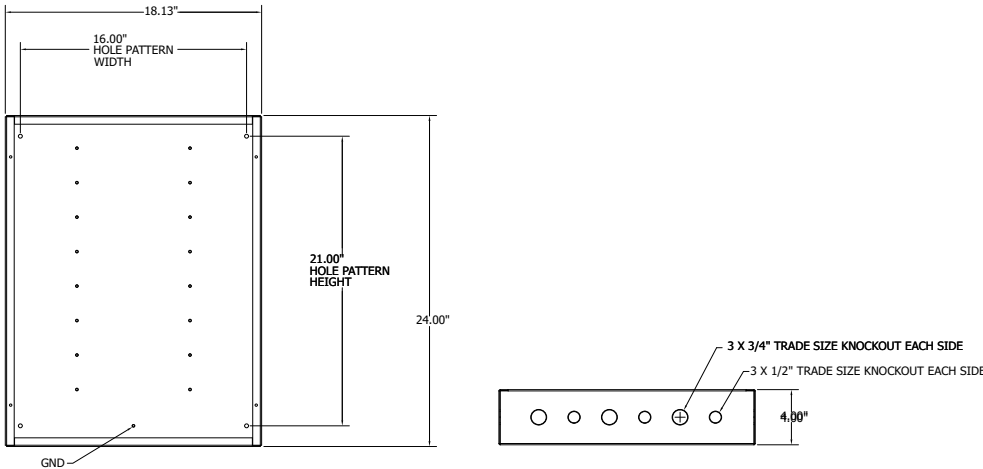

## Cabinet Features

- Each cabinet can accommodate up to 8 0-10V driver modules or up to 8 channels of DMX output
- Drivers can be mounted up to 250' away from fixtures
- Symphony cabinets are surface-mounted cabinets
- Low-voltage cabling from driver to fixture(s)

## Symphony Driver Modules: Used with 0-10V Dimming

Fully Digital Controlled Power Source for LED Luminaires

Mounted in Kirlin's **SYM-CABNT**

The **Symphony Configurator** can help determine the necessary components.



Lumens	Driver Module	Maximum Capacity	Fixture Load Examples
-2500L	DVR-1400A	Qty 1: 2500L Luminaire	• Qty 1: SRR-06610-2500L
	DVR-1400B	Qty 2: 2500L Luminaires, wired in series	• Qty 2: SRR-06610-2500L • Qty 1: SRR-06610-2500L and Qty 1: SRR-07604-2500L
-4000L	DVR-1050A	Qty 1: 4000L Luminaire	• Qty 1: SRR-06610-4000L
	DVR-1050C*	Qty 2: 4000L Luminaires, 1 per LED output	• Qty 2: SRR-06610-4000L • Qty 1: SRR-06610-4000L and Qty 1: SRR-07604-4000L
-5000L	DVR-1400B	Qty 1: 5000L Luminaire	• Qty 1: SRR-06610-5000L

\* 100W DVR-XXXXC driver modules have 2 LED outputs each.

## Symphony DMX Power Supplies: Used with DMX Control

Pre-wired Symphony DMX power supplies (**SYM-DMXPS**) have a maximum of 8 channels each.

Each channel is pre-wired for 1400mA and 1050mA output. Ensure appropriate current is selected when wiring.

The **Symphony Configurator** can help determine the necessary components.

Lumens	LED Channel Output	
	1400mA	1050mA
-2500L Luminaire	1 fixture per channel	
-4000L Luminaire		1 fixture per channel
-5000L Luminaire	2 channels per fixture	

## Dimensions

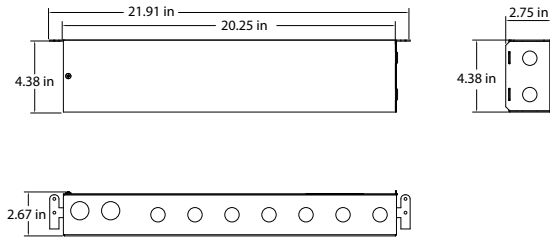

## REM-SWCAB Features

- Drivers can be mounted up to 250' away from fixtures
- Remote mini-cabinets are plenum rated and can be mounted to the ceiling grid
- Low-voltage cabling from driver to fixture(s)
- 1/2" and 3/4" knockouts

**50W and 75W Drivers** Exact dimensions of drivers inside the box may vary based on options chosen.

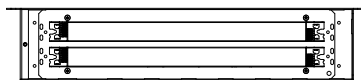

**100W Drivers**

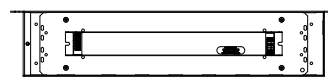

## 0-10V Remote Mini-Cabinet Options and Ordering Configuration

(Example: REM-SWCAB-1400B-2-D2-EMI)

Must Specify				Optional
Model	Driver Current	Driver Count	Dimming	Other Options
REM-SWCAB				
	<b>50 Watt Drivers</b> -1050A: 1050mA 50W driver; powers (1) 4000L fixture -1400A: 1400mA 50W driver; powers (1) 2500L fixture <b>75 Watt Drivers</b> -1400B: 1400mA 75W driver; powers (2) 2500L fixtures OR (1) 5000L fixture <b>100 Watt Drivers</b> -1050C: 1050mA 100W driver; powers (2) 4000L fixtures	-1: 1 driver -2: 2 drivers; N/A on -1400C driver option	-D2: 0-10V 0.1% dim	<b>(Blank):</b> None  -E15: Remote emergency micro-inverter: 50W max load; 90+ minutes run time  -EMI: Remote emergency mini-inverter: 125W max load; 90+ minutes run time

Lumens	Remote Mini-Cabinet	Driver Wattage	Maximum Capacity	
			1 Driver in REM Cabinet	2 Drivers in REM Cabinet
-2500L	REM-SWCAB-1400A	50W	Qty 1: 2500L Luminaire	Qty 2: 2500L Luminaires, (1 per driver)
	REM-SWCAB-1400B	75W	Qty 2: 2500L Luminaires, wired in series	Qty 4: 2500L Luminaires, (2 per driver, wired in series)
-4000L	REM-SWCAB-1050A	50W	Qty 1: 4000L Luminaire	Qty 2: 4000L Luminaires, (1 per driver)
	REM-SWCAB-1050C*	100W	Qty 2: 4000L Luminaires, 1 per LED output	N/A
-5000L	REM-SWCAB-1400B	75W	Qty 1: 5000L Luminaire	Qty 2: 5000L Luminaires, (1 per driver)

\* 100W XXXXC remote drivers have 2 LED outputs each

See next page for DMX Remote Mini-Cabinet Options and Ordering Configuration

## DMX Remote Mini-Cabinet Options and Ordering Configuration

(Example: REM-SWCAB-DMX2C-2-16B-EMI)

Must Specify				Optional
Model	Driver Current	Driver Count	Dimming Resolution	Other Options
REM-SWCAB				
	<b>50 Watt Drivers</b> <b>-DMX2C:</b> 50W driver with two outputs, programmed to 1400mA and 1050mA	<b>-1:</b> 1 driver <b>-2:</b> 2 drivers	<b>(Blank):</b> 8-bit DMX-RDM Dimming to 0.1%  <b>-16B:</b> 16-bit DMX-RDM Dimming to 0.1%	<b>(Blank):</b> None  <b>-EI5:</b> Remote emergency micro-inverter: 50W max load; 90+ minutes run time <b>-EMI:</b> Remote emergency mini-inverter: 125W max load; 90+ minutes run time

Lumens	Remote Mini-Cabinet	Selected Output	Driver Wattage	Maximum Capacity	
				1 Driver in REM Cabinet	2 Drivers in REM Cabinet
-2500L	REM-SWCAB-DMX2C	1400mA	50W	Qty 1: 2500L Luminaire	Qty 2: 2500L Luminaires, (1 per driver)
-4000L	REM-SWCAB-DMX2C	1050mA	50W	Qty 1: 4000L Luminaire	Qty 2: 4000L Luminaires, (1 per driver)
-5000L	REM-SWCAB-DMX2C	1400mA	50W	Qty 0.5: 5000L Luminaire (uses 2 drivers per fixture)	Qty 1: 5000L Luminaire (uses 2 drivers per fixture)