

CATALOG #	TYPE	
JOB NAME	WATTAGE	VOLTAGE

# Latitudes Series

## Open Appearance 6" Downlight • LED

Up to 60,000 Hour Rated Life • Wet Listed

LM-79 Certified • LM-80 Qualified

# LRR-06405

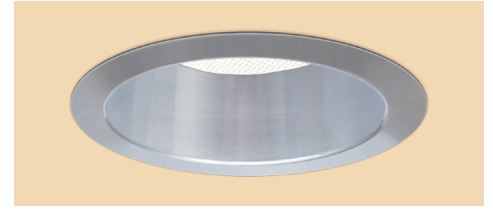

## Specifications

### Delivered System Performance

- Nominal Lumens: **Must Specify**

#### Non-IC

-5000L

-3500L

-2500L

- Select trim & beam distribution: see chart
- Select color (CCT): see chart; 80+ CRI standard; Option -HC for 90+ (15% lumen loss)
- 60,000 Hour Rated Life (L70)

### Thermal Protection: SPECIFY VOLTAGE

- Thermal protector for insulation detection per UL/NEC. Must specify input voltage

### Thermal Management System

- Aluminum heat sink and components for cool operation, long life, and low maintenance

### LED Driver - INTERNAL or REMOTE

- Indoor/Outdoor: -30°C to 60°C (-22°F to 140°F)
- Remote driver in mini cabinet available, see option -REM
- 0-10V CCR 10% dimming standard
- 120-277V / 50-60 Hz standard; load insensitive

### Trim Assembly

- Clear specular aluminum trim
- Self-flanged, low glare cone with lens above
- Optional colors and finishes available

### Acrylic Enameled Aluminum Housing

- Rustproof and corrosion resistant: exceeds 1000 hour ASTM 5% salt spray test
- Shallow depth fits restricted plenums
- Cool operation extends component life
- Modular design; visible and fully serviceable through aperture
- Built-in plaster flange

### Outlet Box (Galvanized)

- UL Listed, 14GA, insulated, removable cover
- ½" and ¾" knockouts

### Installation & Hardware

- Indoor/outdoor in ceilings up to 1½" thick
- Compatible with fire rated enclosures (by others)
- 27" hanger bars & adjusting brackets (2) supplied

### UL, C-UL (Canada)

- UL Listed: wet, damp or dry locations, covered ceilings
- Through-branch conductors (4 #12 AWG 90°C)

### IEC & FCC Compliance

- Meets IEC/EN 60601-1-2 electromagnetic compatibility standard for medical electrical equipment
- FCC Part 15 certified for EMI/RFI emissions

### FIVE YEAR Limited Warranty

- Complete standard fixture

### Maintenance and Future-Proofing

- M1 maintenance level standard- Phillips head screwdriver, and/or a basic wrench needed
- Lighthead, driver replaceable through the aperture of the fixture with quick-connections, no soldering required
- Backed by Kirlin's [25-Year Legacy Support Guarantee](#)



## Available Maintenance Levels

Level	Option	Tools Required to Service LED Module and Driver
	Standard	<ul style="list-style-type: none"> <li>• Phillips head screwdriver, and/or a basic wrench needed</li> </ul>

## Options and Ordering Configuration

(Example: LRR-06405-2500L-120-MFL-35K-30T-RH-NAT)

Must Specify					Optional			
Model	Lumens	Volts	Beam	CCT <sup>†</sup> & CRI	Driver Options	Emergency Options	Trim Options	Other Options
LRR-06405	-5000L -3500L -2500L	-120 -277 -97 <sup>†</sup> : Other Voltage	(Blank): MFL  -SPT -MFL -WFL	(Blank): 3500K, 80+ CRI  <b>80+ CRI*</b> -27K: 2700°K -30K: 3000°K -35K: 3500°K -41K: 4000°K -50K: 5000°K  *Note: Lumen Factor = 0.93 for -27K <b>90+ CRI**</b> -27K-HC: 2700°K -30K-HC: 3000°K -35K-HC: 3500°K -41K-HC: 4000°K -50K-HC: 5000°K  **Note: Lumen Factor = 0.79 for -27K-HC; All Others = 0.85; Consult Factory	(Blank): Standard 0-10V CCR 10% dim  -D1: 0-10V 1.0% dim -D2: 0-10V 0.1% dim -D3: DALI 1.0% dim -D4: DALI 100-0.1% dim -D5: DMX512A 0% dimming instead for -3500L or -2500L only -D40: -40°C (-40°F) driver; 0-10V 10% dim -ECO: Digital driver for Lutron EcoSystem controls. Dims to 1% or consult factory; -3500L max -REM: Driver remote mounted in mini-cabinet; see next page for driver ordering - MUST BE ORDERED SEPARATELY	(Blank): None  -EI: Remote emergency inverter for 50% of rated lumens for -5000L or -3500L. Not available for -2500L. Run time: 90+ minutes. 120 or 277V, 60Hz input only. Specify voltage. Not for use with Option -FS -EM: Internal emergency battery pack; Delivers 500 lumens; Run time: 90+ minutes -ERH: Remote emergency battery pack; Delivers 1000 lumens; CEC Compliant; Run time: 90+ minutes	(Blank): Standard clear specular trim; low glare cone with lens above  <b>Trim Finishes</b> -30F: White enamel (flange only) -30T: White enamel (complete trim) -35F: Silver enamel (flange only) -35T: Silver enamel (complete trim) -37F: Dark bronze enamel (flange only) -37T: Dark bronze enamel (complete trim) -38F: Black enamel (flange only) -38T: Black enamel (complete trim) -70T: Clear semi-specular SofTex™ (complete trim) -94: Custom color; consult factory <b>Other Trim Features</b> -13: Clear poly lens below lens. Photometric distribution unaffected -23: Frosted microprismatic lens -32: White trim extender, specify OD -33: Decorative Glow Ring; see last page for details -45: Gasket between trim & ceiling -WA: White acrylic lens	(Blank): None  <b>Mounting</b> -79: Extension collar for ceilings up to 2" thick -RH: Joist mounting hardware instead  <b>Other Options</b> -99: Special modification; consult factory -AWN: Athena Wireless Node; N/A for Dimming Options -D5, -D40, -ECO -FS: Fused primary; One per fixture; N/A for option -EI NAT: Modified for natatorium use SH: Sealed housing and junction box -TA: Top access for servicing from above ceiling  *Note: For other integrated control solutions, such as nLight, contact factory

†Consult  
factory

## Static White Options and Ordering Configuration

(Example: REM-SWCAB-1400B-2-D2-EMI)

Must Specify				Optional
Model	Driver Current	Driver Count	Dimming	Other Options
REM-SWCAB				
	<b>50 Watt Drivers</b> -1050A: 1050mA 50W driver; powers (1) 3500L fixture -1400A: 1400mA 50W driver; powers (1) 2500L fixture <b>75 Watt Drivers</b> -1400B: 1400mA 75W driver; powers (2) 2500L fixtures OR (1) 5000L fixture <b>100 Watt Drivers</b> -1050C: 1050mA 100W driver; powers (2) 3500L fixtures	-1: 1 driver -2: 2 drivers; N/A on -1050C driver option	-D0: 0-10V 10% dim -D1: 0-10V 1.0% dim -D2: 0-10V 0.1% dim -D3: DALI 1.0% dim -D4: DALI 100-0.1% dim -D5: DMX512A 0% dimming instead; only available with -1050A option -ECO: Digital driver for Lutron EcoSystem controls. Dims to 1% or consult factory; -3500L max	<b>(Blank):</b> None -E15: Remote emergency micro-inverter: 50W max load; 90+ minutes run time -EMI: Remote emergency mini-inverter: 125W max load; 90+ minutes run time

Lumens	Remote Mini-Cabinet	Driver Wattage	Maximum Capacity	
			1 Driver in -REM Cabinet	2 Drivers in -REM Cabinet
-2500L	REM-SWCAB-1400A	50W	Qty 1: 2500L Luminaire	Qty 2: 2500L Luminaires, (1 per driver)
	REM-SWCAB-1400B	75W	Qty 2: 2500L Luminaires, wired in series	N/A
-3500L	REM-SWCAB-1050A	50W	Qty 1: 3500L Luminaire	Qty 2: 3500L Luminaires (1 per driver)
	REM-SWCAB-1050C*	100W	Qty 2: 3500L Luminaires, wired in series	N/A
-5000L	REM-SWCAB-1400B	75W	Qty 1: 5000L Luminaire	Qty 2: 5000L Luminaires (1 per driver)

\* 100W XXXXC remote drivers have 2 LED outputs each

### Dimensions

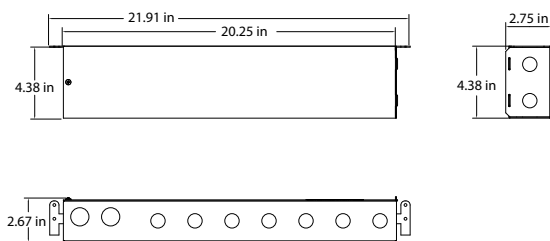

### -REM Features

- Drivers can be mounted up to 250' away from fixtures
- Remote mini-cabinets are plenum rated and can be mounted to the ceiling grid
- Low-voltage cabling from driver to fixture(s)
- 1/2" and 3/4" knockouts

**50W and 75W Drivers** Exact dimensions of drivers inside the box may vary based on options chosen.

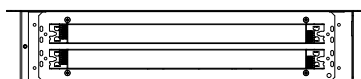

**100W Drivers**

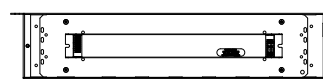



# Classic Glow Rings: Option -33 for Latitudes

To order a Kirlin Glow Ring, begin by adding -33 to the product number. Then, configure your Glow Ring by selecting each of the 7 design elements listed below:

**(Example: LRR-06405-5000L-120-30K-WFL-33-GLM-1L-FRR-ROF-SIF-ROS-SIS)**

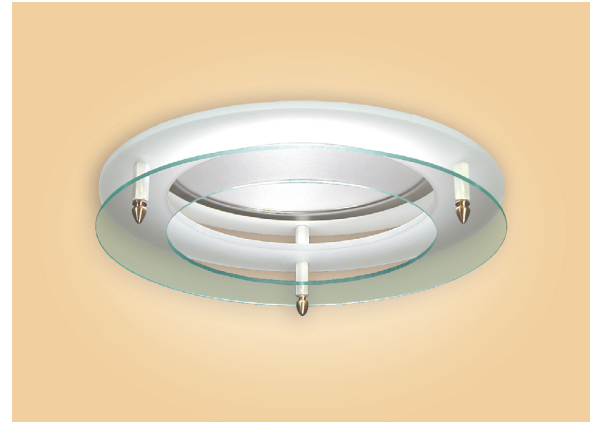

1. Ring Material  
(choose one)

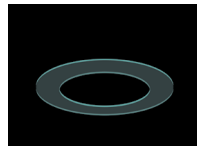

Glass (-GLM)

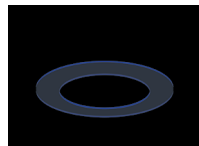

Acrylic (-ACM)



Custom (-CUM)

2. # of Rings  
(choose one)

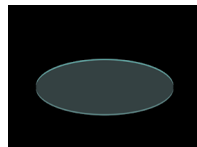

1 Ring (1L)

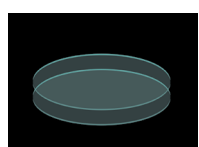

2 Rings (-2L)

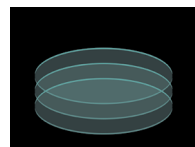

3 Rings (-3L)

3. Ring Design  
(choose one)

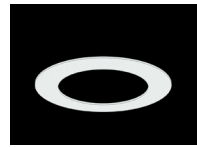

Frosted Ring (-FRR)



Clear Ring (-CRR)

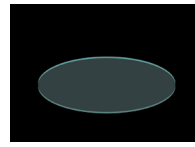

Solid Disk (-SDR)

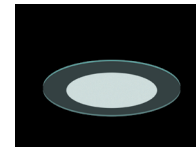

Frosted Center (-FCR)

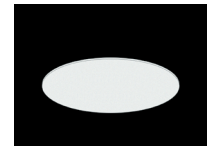

Frosted Disk (-FDR)

4. Finial Design  
(choose one)

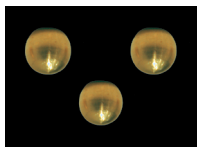

Round (-ROF)



Knurled (-KNF)

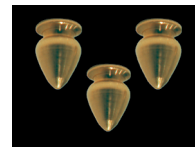

Cone (-COF)

5. Finial Color  
(choose one)



Brass (-BRF)



Silver (-SIF)



Black (-BLF)

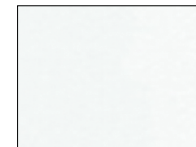

White (-WHF)



Custom (-CUF)

6. Standoff Design  
(choose one)

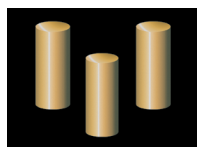

Round (-ROS)

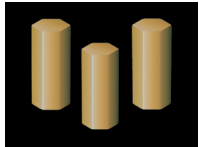

Hexagonal (-HOS)

7. Standoff Color  
(choose one)



Brass (-BRS)



Silver (-SIS)



Black (-BLS)



White (-WHS)



Custom (-CFS)